



JACKSONVILLE WASTEWATER UTILITY

248 Cloverdale Rd.
Jacksonville, AR 72076
501-982-0581

No. 08-0199

RESIDENTIAL OR COMMERCIAL BUILDING SEWER CONNECTION PERMIT

Street Address 1607 Lost Creek Dr.

Legal Description Lost Creek Ph I Lot # 34

Facility to be connected to sewer:

Single Family Residence ☒ *Multi-family Residential ☐ Units

*Commercial Installation ☐ Description: New Connection

Water Meter (s) Size 513

* Commercial installations, and multi-family installations of more than 4 dwelling units must be accompanied by a site plan showing the proposed building sewer.

Sewer line installation by Foster Pina 454-0368

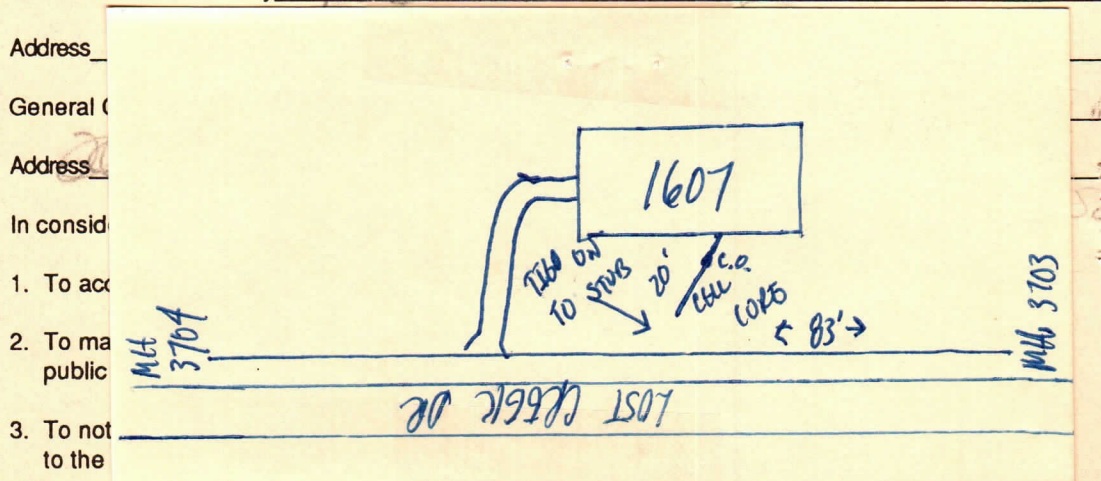

Fees:	Connection Fee	\$ <u>152</u>	7-2-08	Receipt No. <u>0230</u>
	Tap Charge	\$ <u> </u>		Receipt No. <u> </u>
	Inspection Fee	\$ <u>25.00</u>	8-22-08	Receipt No. <u>0295</u>
	Street Cut	\$ <u> </u>		Receipt No. <u> </u>

APPLICANT
Signed Paul Falmer

☐ Plumbing Contractor
☐ General Contract
☐ Owner (Address)

APPROVED
Jacksonville Wastewater Utility

By: [Signature] Date: 6/27/08

Completed
9/11/08