



No 614

## JACKSONVILLE WASTEWATER UTILITY

## RESIDENTIAL OR COMMERCIAL BUILDING SEWER CONNECTION PERMIT

Street Address 1700 John HARDENLegal Description (SHONEYS)

Facility to be connected to sewer:

Single Family Residence \_\_\_\_\_ \*Multi-family Residential \_\_\_\_\_ Units \_\_\_\_\_

\*Commercial Installation ☒ Description: (NEW) (Rest nt)Water Meter (s) size 1"

\*Commerical installations, and multi-family installations of more than 4 dwelling units must be accompanied by a site plan showing the proposed building sewer.

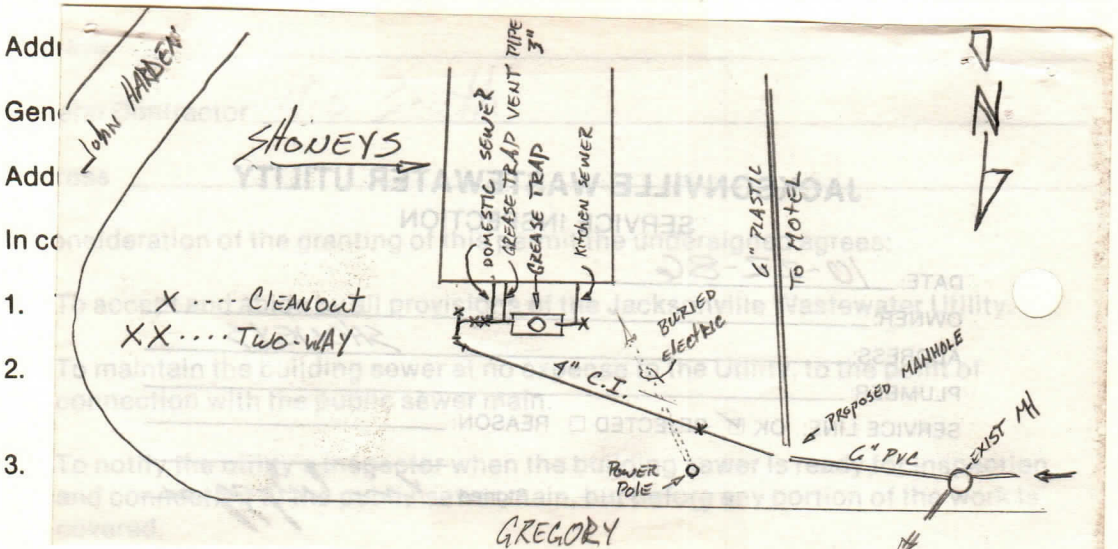
Sewer line installation by STEVE Conley

Fees: Connection Fee \$ 100.00  
Tap Charge \$ \_\_\_\_\_  
Inspection Fee \$ 6.00  
Total Fees \$ 106.00

Receipt No. 2499 10/27/14  
Receipt No. \_\_\_\_\_  
Receipt No. 2499 10/27/14

## APPLICANT

Signed [Signature]

- ☒ Plumbing Contractor  
☐ General Contract  
☐ Owner (Address \_\_\_\_\_)

APPROVED  
Jacksonville Wastewater Utility

By: [Signature]Date: 10/27/14



# JACKSONVILLE WASTEWATER UTILITY

248 Cloverdale Road · P.O. Box 69  
Jacksonville, AR 72078-0069  
982-0581

No. 05-0077

## RESIDENTIAL OR COMMERCIAL BUILDING SEWER CONNECTION PERMIT

Street Address 1760 John Harden

Legal Description Alcove

Facility to be connected to sewer:

Single Family Residence \_\_\_\_\_ \*Multi-family Residential \_\_\_\_\_ Units \_\_\_\_\_

\*Commercial Installation ☒ Description: Replacement

Water Meter (s) Size \_\_\_\_\_

\* Commercial installations, and multi-family installations of more than 4 dwelling units must be accompanied by a site plan showing the proposed building sewer.

Sewer line installation by Shoney's

Address \_\_\_\_\_

General \_\_\_\_\_

Address \_\_\_\_\_

In consid \_\_\_\_\_

1. To ac \_\_\_\_\_

2. To ma \_\_\_\_\_  
public

3. To not \_\_\_\_\_  
to the

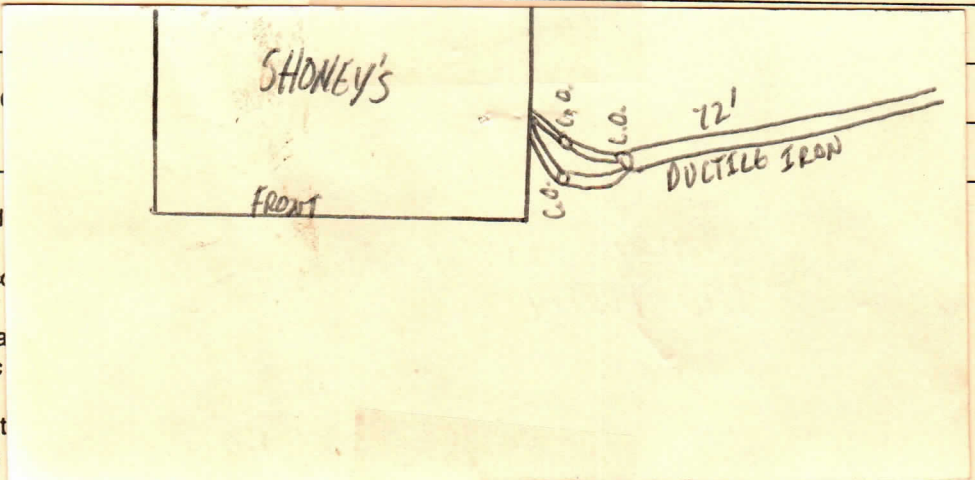

Fees: Connection Fee \$ \_\_\_\_\_ Receipt No. \_\_\_\_\_

Tap Charge \$ \_\_\_\_\_ Receipt No. \_\_\_\_\_

Inspection Fee \$ 12.00 Receipt No. 2069

Street Cut \$ \_\_\_\_\_ Receipt No. \_\_\_\_\_

APPLICANT  
Signed Jim Ror MP 5372

- ☐ Plumbing Contractor  
☐ General Contract  
☐ Owner (Address \_\_\_\_\_)

APPROVED  
Jacksonville Wastewater Utility

By: Shoney's Date: 6/20/05





JACKSONVILLE WASTEWATER UTILITY  
248 Cloverdale Rd.  
Jacksonville, AR 72076  
501-982-0581

No. 14- 0093

### RESIDENTIAL OR COMMERCIAL BUILDING SEWER CONNECTION PERMIT

Street Address 1700 John Hardin

Legal Description \_\_\_\_\_

Facility to be connected to sewer:

Single Family Residence \_\_\_\_\_ \*Multi-family Residential \_\_\_\_\_ Units \_\_\_\_\_

\*Commercial Installation \_\_\_\_\_ Description: Replacement

Water Meter (s) Size \_\_\_\_\_

\* Commercial installations, and multi-family installations of more than 4 dwelling units must be accompanied by a site plan showing the proposed building sewer.

Sewer line installation by Master Plumbing - Charles 982-5042

Address \_\_\_\_\_

General Co \_\_\_\_\_

Address \_\_\_\_\_

In considera \_\_\_\_\_

1. To accep \_\_\_\_\_

2. To maint  
public se \_\_\_\_\_

3. To notify  
to the pul \_\_\_\_\_

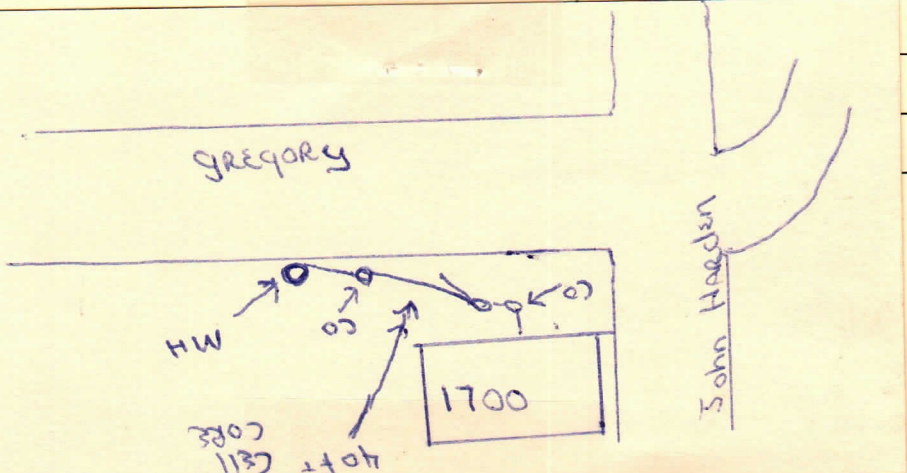

Fees: Connection Fee \$ \_\_\_\_\_

Receipt No. \_\_\_\_\_

Tap Charge \$ \_\_\_\_\_

Receipt No. \_\_\_\_\_

Inspection Fee \$ 25.00

Receipt No. on acct

Street Cut \$ \_\_\_\_\_

Receipt No. \_\_\_\_\_

APPLICANT

Signed on file

☐ Plumbing Contractor

☐ General Contract

☐ Owner (Address \_\_\_\_\_)

APPROVED

Jacksonville Wastewater Utility

By: [Signature]

Date: 8/28/14

complete  
8/28/14  
KA