



# JACKSONVILLE WASTEWATER UTILITY

248 Cloverdale Rd.  
Jacksonville, AR 72076  
501-982-0581

No. 06- 0037

## RESIDENTIAL OR COMMERCIAL BUILDING SEWER CONNECTION PERMIT

Street Address 1701 Hidden Oaks Drive

Legal Description Lot 23 Hidden Oaks

Facility to be connected to sewer:

Single Family Residence X \*Multi-family Residential \_\_\_\_\_ Units \_\_\_\_\_

\*Commercial Installation \_\_\_\_\_ Description: \_\_\_\_\_

Water Meter (s) Size 3/8

\* Commercial installations, and multi-family installations of more than 4 dwelling units must be accompanied by a site plan showing the proposed building sewer.

Sewer line installation by A+M Plumbing

Address

General

Address

In cons

1. To a

2. To r

publ

3. To n

to th

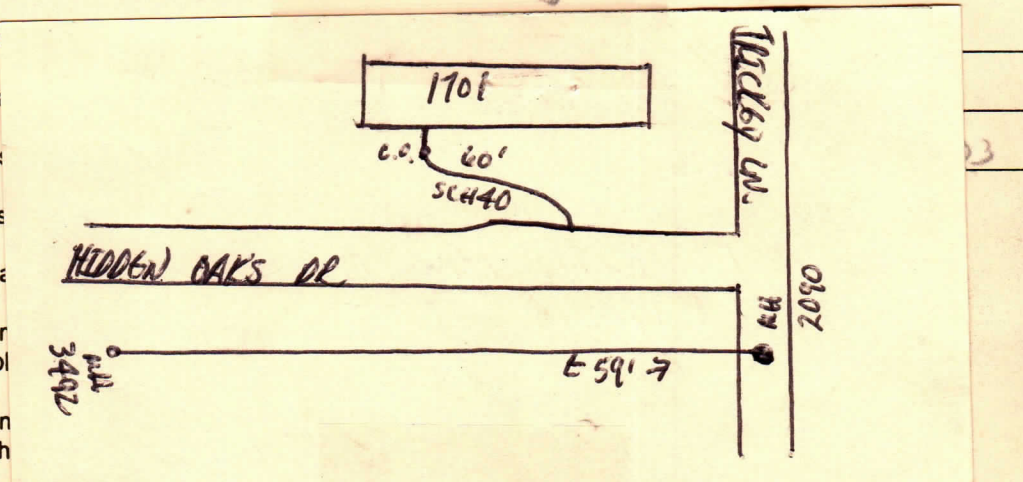

Fees: Connection Fee \$ 12.00 Receipt No. 0071

Tap Charge \$ \_\_\_\_\_ Receipt No. \_\_\_\_\_

Inspection Fee \$ 12.00 8/16/06 Receipt No. on acct.

Street Cut \$ \_\_\_\_\_ Receipt No. \_\_\_\_\_

APPLICANT

Signed [Signature]

☐ Plumbing Contractor

☐ General Contract

☐ Owner (Address \_\_\_\_\_)

APPROVED

Jacksonville Wastewater Utility

By: [Signature] Date: 3-28-06

Darryl  
8/16/06

Inspected  
8/16/06