



JACKSONVILLE WASTEWATER UTILITY

0121

RESIDENTIAL OR COMMERCIAL BUILDING SEWER CONNECTION PERMIT

Street Address 1701 T.P. WHITE

Legal Description _____

Facility to be connected to sewer:

Single Family Residence _____ *Multi-family Residential _____ Units _____

*Commercial Installation ☒ Description: NEW HARDEES RESTAURANT

Water Meter (s) size 1 1/2

*Commerical installations, and multi-family installations of more than 4 dwelling units must be accompanied by a site plan showing the proposed building sewer.

Sewer line installation by KUNKENBELL MECHANICAL

Address _____

General Co _____

Address _____

In consider _____

1. To acc _____

2. To main
connec _____

3. To notifi
and cor
coverec _____

Fees: C _____

Tap Charge \$ 29.44

Inspection Fee \$ 1.00

Total Fees \$ 173.44

Receipt No. 1541 12/13/84

Receipt No. 1541 12/13/84

APPLICANT

Signed M. Kunkendall

☒ Plumbing Contractor

☐ General Contract

☐ Owner (Address _____)

APPROVED

Jacksonville Wastewater Utility

By: J. T. Stephens Date: Dec 18, 1984

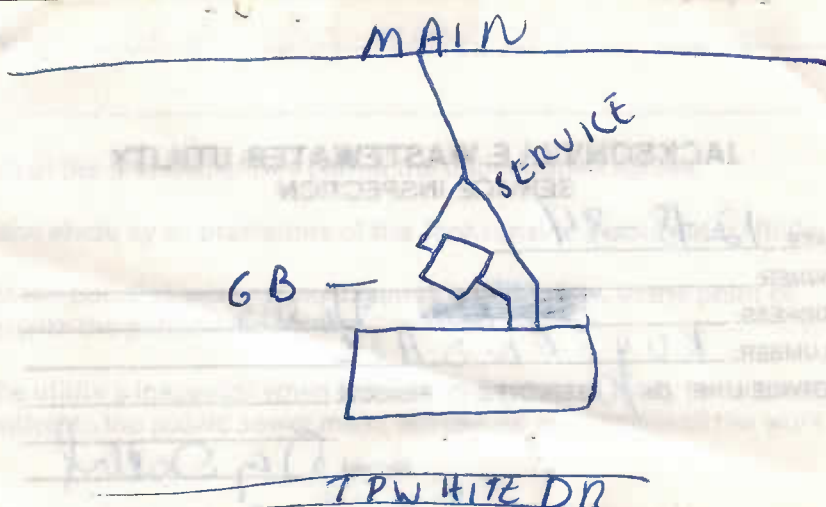



No. 94- 038

JACKSONVILLE WASTEWATER UTILITY248 Cloverdale Road • P.O. Box 69
Jacksonville, AR 72078-0069
982-0581**RESIDENTIAL OR COMMERCIAL BUILDING SEWER CONNECTION PERMIT**Street Address 1701 J.P. White Dr. - Hurrell

Legal Description _____

Facility to be connected to sewer:

Single Family Residence _____ *Multi-family Residential _____ Units _____

*Commercial Installation / Description: ReplacementWater Meter (s) Size 1"

* Commercial installations, and multi-family installations of more than 4 dwelling units must be accompanied by a site plan showing the proposed building sewer.

Sewer line installation by Rita Rouse

Address _____

General _____

Address _____

In connection _____

1. To _____

2. To _____ put _____

3. To _____ to t _____

Fees: _____

Inspection Fee \$ 6.00Receipt No. 7012Total Fees \$ 6.00APPLICANT
Signed [Signature]

- ☒ Plumbing Contractor
☐ General Contract
☐ Owner (Address _____)

APPROVED
Jacksonville Wastewater UtilityBy: [Signature] Date: 2-7-94



JACKSONVILLE WASTEWATER UTILITY
248 Cloverdale Rd.
Jacksonville, AR 72076
501-982-0581

No. 14- 0163

RESIDENTIAL OR COMMERCIAL BUILDING SEWER CONNECTION PERMIT

Street Address 1701 TP. White

Legal Description _____

Facility to be connected to sewer:

Single Family Residence _____ *Multi-family Residential _____ Units _____

*Commercial Installation _____ Description: New Connection

Water Meter (s) Size _____

* Commercial installations, and multi-family installations of more than 4 dwelling units must be accompanied by a site plan showing the proposed building sewer.

Sewer line installation by Vogele Mechanical Rec 944-4163

Address Reagan Head - MP 5969

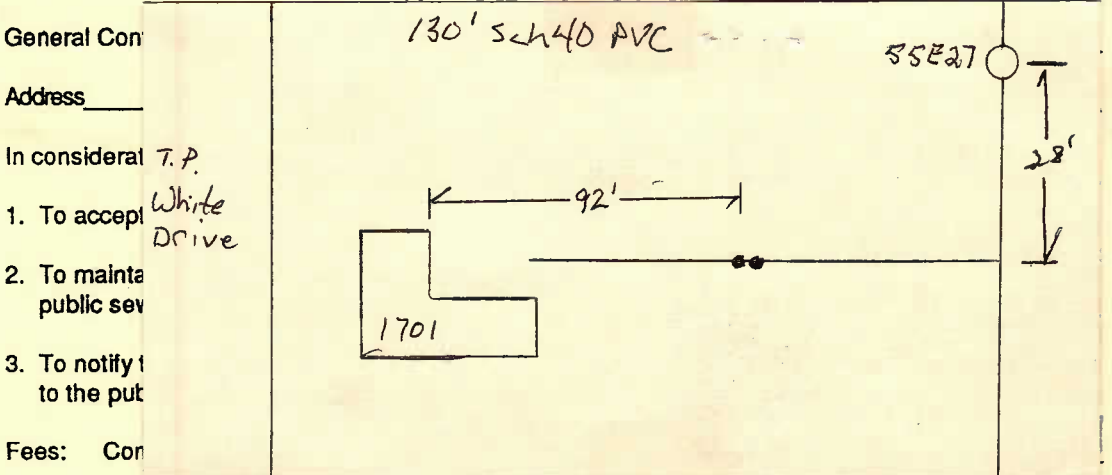

Tap Charge \$ _____

Receipt No. _____

Inspection Fee \$ 25.00

Receipt No. 423829

Street Cut \$ _____

Receipt No. _____

APPLICANT Signed Randy L. Zimster

- ☐ Plumbing Contractor
☐ General Contract
☐ Owner (Address _____)

APPROVED
Jacksonville Wastewater Utility

By: [Signature] Date: 11/13/14

Completed
11/20/14
W