



No. 87- 00076

JACKSONVILLE WASTEWATER UTILITY

RESIDENTIAL OR COMMERCIAL BUILDING SEWER CONNECTION PERMIT

Street Address 1802 N. W. 104th

Legal Description _____

Facility to be connected to sewer:

Single Family Residence _____ * Multi-family Residential _____ Units _____

* Commercial Installation _____ Description: Replacement

Water Meter (s) size 3/4"

* Commerical installations, and multi-family installations of more than 4 dwelling units must be accompanied by a site plan showing the proposed building sewer.

Sewer line installation by Michael Miller

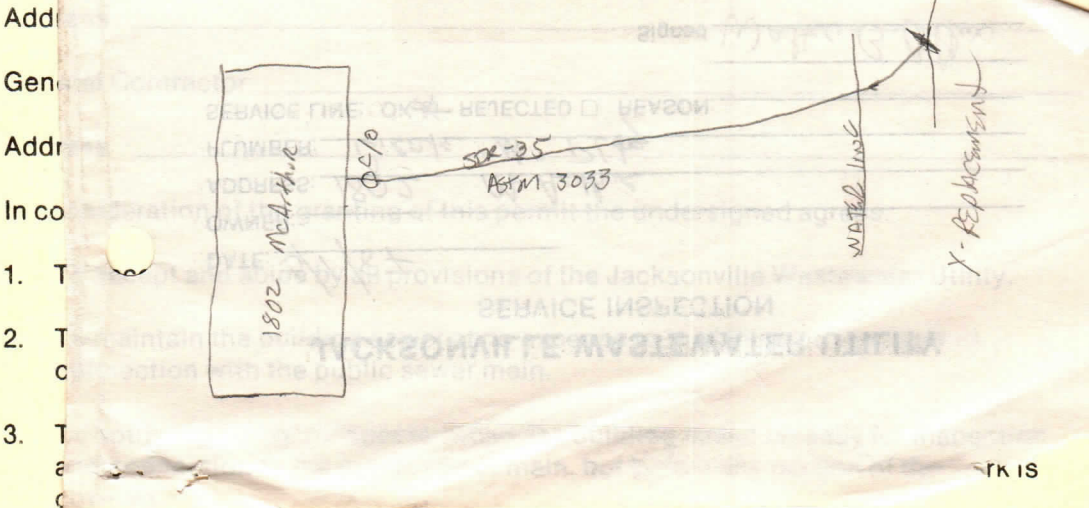

Fees:	Connection Fee	\$ _____	Receipt No. _____
	Tap Charge	\$ _____	Receipt No. _____
	Inspection Fee	\$ <u>6.00</u>	Receipt No. <u>5736</u>
	Total Fees	\$ <u>6.00</u>	

APPLICANT
Signed Michael Miller
☐ Plumbing Contractor
☐ General Contract
☐ Owner (Address _____)

APPROVED
Jacksonville Wastewater Utility

By: Michael Miller Date: 5/1/87



No. 05-0313

JACKSONVILLE WASTEWATER UTILITY248 Cloverdale Road • P.O. Box 69
Jacksonville, AR 72078-0069
982-0581**RESIDENTIAL OR COMMERCIAL BUILDING SEWER CONNECTION PERMIT**Street Address 1802 McArthur

Legal Description _____

Facility to be connected to sewer:

Single Family Residence ☒ *Multi-family Residential _____ Units _____*Commercial Installation _____ Description: replacementWater Meter (s) Size 5/8"

* Commercial installations, and multi-family installations of more than 4 dwelling units must be accompanied by a site plan showing the proposed building sewer.

Sewer line installation by AAA Plumber

Address _____

General Contractor _____

Address _____

In consideration of the granting of this permit the undersig

1. To accept and abide by all provisions of the Jacksonville
2. To maintain the building sewer at no expense to the Utility public sewer main.
3. To notify the utility's inspector when the building sewer to the public sewer main, but before any portion of the

Fees: Connection Fee \$ _____

Tap Charge \$ _____

Inspection Fee \$ 12.00

Street Cut \$ _____

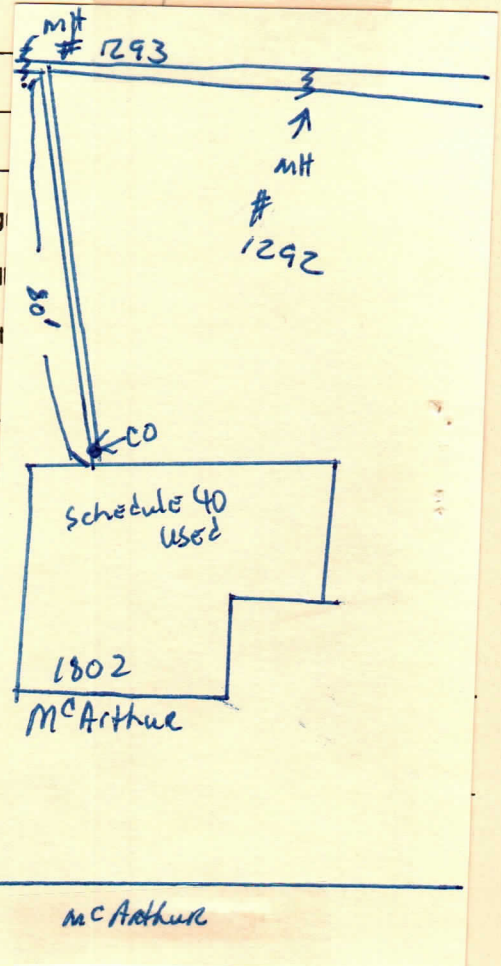
APPLICANTSigned by plc☐ Plumbing Contractor☐ General Contract☐ Owner (Address _____)**APPROVED**

Jacksonville Wastewater Utility

By: Cathy ReedDate: 12/12/05Inspected 12/12/05