



No. 03-0116

JACKSONVILLE WASTEWATER UTILITY248 Cloverdale Road • P.O. Box 69
Jacksonville, AR 72078-0069
982-0581**RESIDENTIAL OR COMMERCIAL BUILDING SEWER CONNECTION PERMIT**Street Address 1809 Cloverdale Rd.Legal Description Lot #157 Clover Ridge Addition

Facility to be connected to sewer:

Single Family Residence ☒ *Multi-family Residential _____ Units _____

*Commercial Installation _____ Description: _____

Water Meter (s) Size 5/8

* Commercial installations, and multi-family installations of more than 4 dwelling units must be accompanied by a site plan showing the proposed building sewer.

Sewer line installation by Greg Miller

Address _____

General _____

Address _____

In consid _____

1. To acc _____

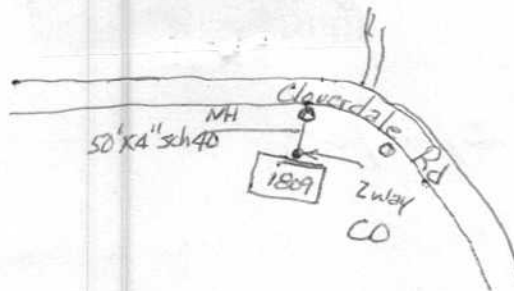
2. To ma
public _____3. To noti
to the p _____Fees: Connection Fee \$ 75. Receipt No. 7529

Tap Charge \$ _____ Receipt No. _____

Inspection Fee \$ 6.00 Receipt No. 4173

Street Cut \$ _____ Receipt No. _____

APPLICANTSigned [Signature]☐ Plumbing Contractor☒ General Contract☐ Owner (Address _____)**APPROVED**

Jacksonville Wastewater Utility

By: [Signature] Date: 3/10/03