



No. 06- 0124

JACKSONVILLE WASTEWATER UTILITY

248 Cloverdale Rd.
Jacksonville, AR 72076
501-982-0581

RESIDENTIAL OR COMMERCIAL BUILDING SEWER CONNECTION PERMIT

Street Address 1850 General Samuels Rd

Legal Description Motor Pro

Facility to be connected to sewer:

Single Family Residence _____ *Multi-family Residential _____ Units _____

*Commercial Installation ✓ Description: New Service

Water Meter (s) Size 5/8"

* Commercial installations, and multi-family installations of more than 4 dwelling units must be accompanied by a site plan showing the proposed building sewer.

Sewer line installation by Southern Plumbing 351-3870

Address

General

Address

In code

1. T

2. T

3. T

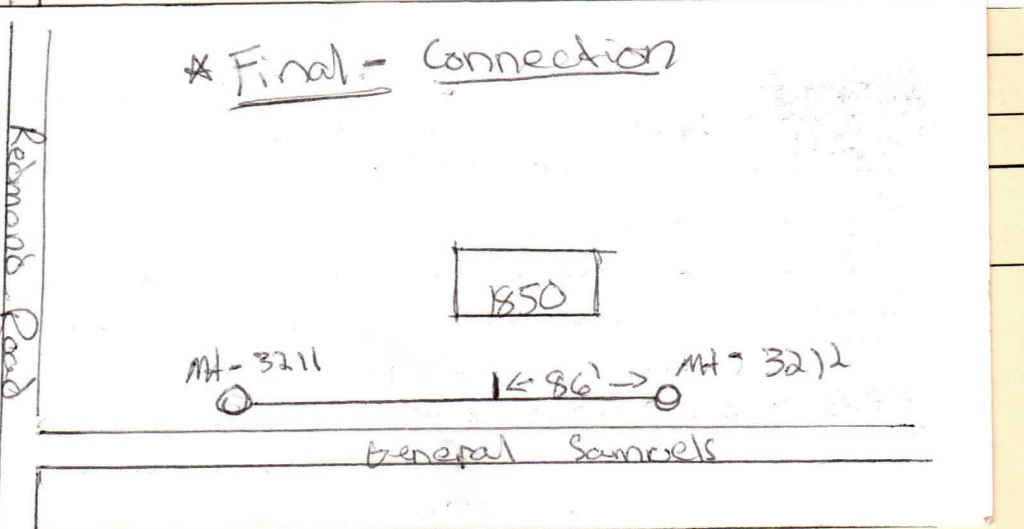
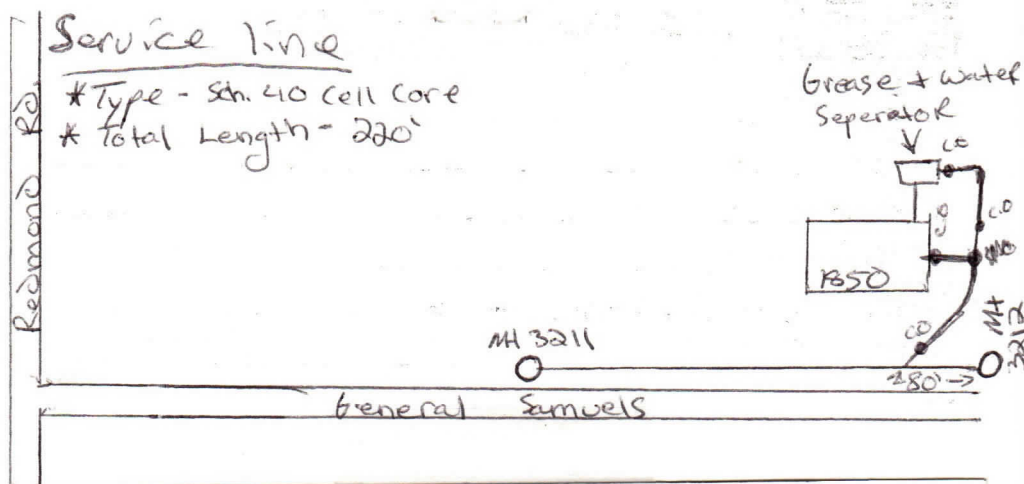

By: Paul Rendence Date: 6-28-06
Paul Partial 6/28/06 Final Inspection 6-29-06

SLD

No. 25- 0083



JACKSONVILLE WASTEWATER UTILITY
 248 Cloverdale Rd.
 Jacksonville, AR 72076
 501-982-0581

RESIDENTIAL OR COMMERCIAL BUILDING SEWER CONNECTION PERMIT

Street Address 1850 General Samuels

Legal Description _____

Facility to be connected to sewer:

Single Family Residence ☒ *Multi-family Residential _____ Units _____

*Commercial Installation _____ Description: Repair Cleanout

Water Meter (s) Size 5/8

* Commercial installations, and multi-family installations of more than 4 dwelling units must be accompanied by a site plan showing the proposed building sewer.

Sewer line installation by John Crumley 501-982-0212

Addr _____

Gene _____

Addr _____

In co _____

1. To _____

2. To _____

pu _____

3. To _____

to _____

Fee: Connection Fee \$ _____ Receipt No. _____

Tap Charge \$ _____ Receipt No. _____

Inspection Fee \$ 25.00 Receipt No. 028489

Street Cut \$ _____ Receipt No. _____

APPLICANT

Signed _____

☐ Plumbing Contractor

☐ General Contract

☐ Owner (Address _____), Complete

APPROVED
 Jacksonville Wastewater Utility

By: [Signature] Date: 4/11/2025