



No. 09- 0100

JACKSONVILLE WASTEWATER UTILITY
248 Cloverdale Rd.
Jacksonville, AR 72076
501-982-0581

RESIDENTIAL OR COMMERCIAL BUILDING SEWER CONNECTION PERMIT

Street Address 1900 N. James

Legal Description _____

Facility to be connected to sewer:

Single Family Residence ☒ *Multi-family Residential _____ Units _____*Commercial Installation _____ Description: ReplacementWater Meter (s) Size 3/8"

* Commercial installations, and multi-family installations of more than 4 dwelling units must be accompanied by a site plan showing the proposed building sewer.

Sewer line installation by SLK Quality Plumbing Adv.

Address _____

General _____

Address _____

In consideration of _____

1. To and from _____

2. To and from public _____

3. To and from _____

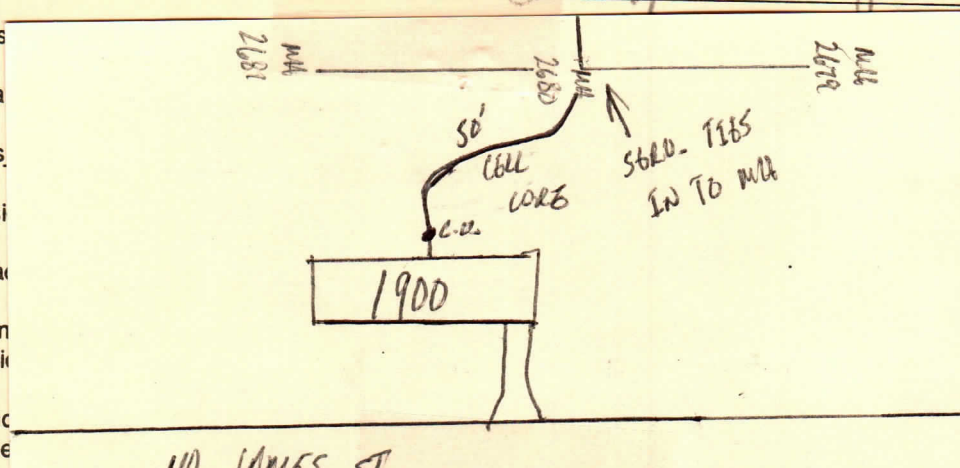

Fees: Connection Fee \$ _____

Receipt No. _____

Tap Charge \$ _____

Receipt No. _____

Inspection Fee \$ 25.00Receipt No. 8247

Street Cut \$ _____

Receipt No. _____

APPLICANT

Signed _____

☐ Plumbing Contractor☐ General Contract☐ Owner (Address _____)

APPROVED

Jacksonville Wastewater Utility

By: Jessica Kendrick Date: 5/18/09

completed
5/18/09