



JACKSONVILLE WASTEWATER UTILITY
248 Cloverdale Rd.
Jacksonville, AR 72076
501-982-0581

No. 15- **000043**

RESIDENTIAL OR COMMERCIAL BUILDING SEWER CONNECTION PERMIT

Street Address 1905 Madden

Legal Description _____

Facility to be connected to sewer:

Single Family Residence _____ *Multi-family Residential _____ Units _____

*Commercial Installation _____ Description: Spot Repair

Water Meter (s) Size 3/8"

* Commercial installations, and multi-family installations of more than 4 dwelling units must be accompanied by a site plan showing the proposed building sewer.

Sewer line installation by JWWU - Cody

Address _____

General _____

Address _____

In consideration _____

1. To _____

2. To _____ public _____

3. To _____ to the _____

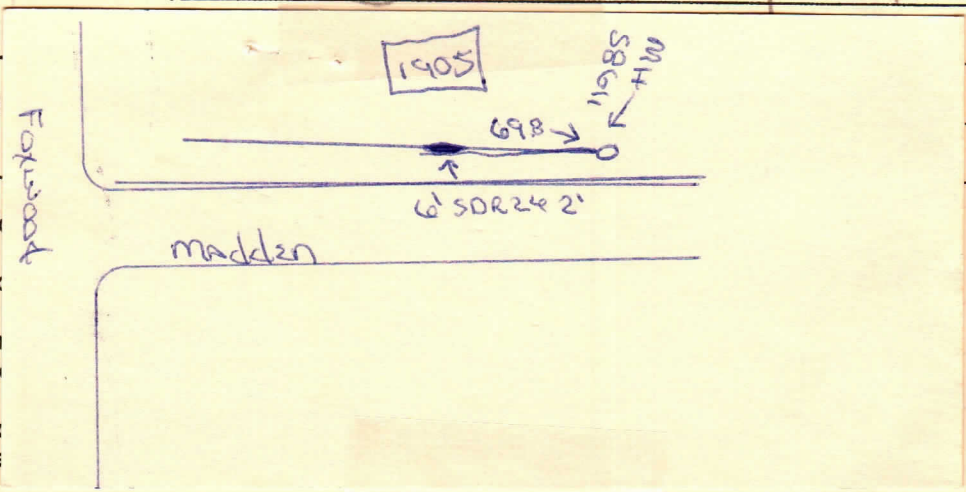

Fees: Connection Fee \$ _____ Receipt No. _____

Tap Charge \$ _____ Receipt No. _____

Inspection Fee \$ ✓ Receipt No. N/C

Street Cut \$ _____ Receipt No. _____

APPLICANT

Signed N/A

☐ Plumbing Contractor

☐ General Contract

☐ Owner (Address _____)

APPROVED
Jacksonville Wastewater Utility

By: Jessica Resendiz Date: 5/12/15

*Complete
5/12/15*