



No. 88-00038

JACKSONVILLE WASTEWATER UTILITY

RESIDENTIAL OR COMMERCIAL BUILDING SEWER CONNECTION PERMIT

Street Address 1906 Jessie Dr.Legal Description Lot 37 Parcel S/D

Facility to be connected to sewer:

Single Family Residence ☒ * Multi-family Residential _____ Units _____* Commercial Installation _____ Description: NewWater Meter (s) size 3/8"

* Commercial installations, and multi-family installations of more than 4 dwelling units must be accompanied by a site plan showing the proposed building sewer.

Sewer line installation by Circle M Plbg.

Add _____

General Contractor _____

Add _____

In consideration of the granting of this permit (which is non-transferable)

1. To accept and abide by all provisions of the Jacksonville Wastewater Utility Code of Ordinances, Chapter 12, Article 1, Section 12-1-1, and all other applicable laws, rules and regulations.

2. To maintain the building sewer and its appurtenances in good condition and to keep the same free from obstructions and to maintain the same in accordance with the standards of the Jacksonville Wastewater Utility.

3. To not use the building sewer for any purpose other than the disposal of sanitary sewage.

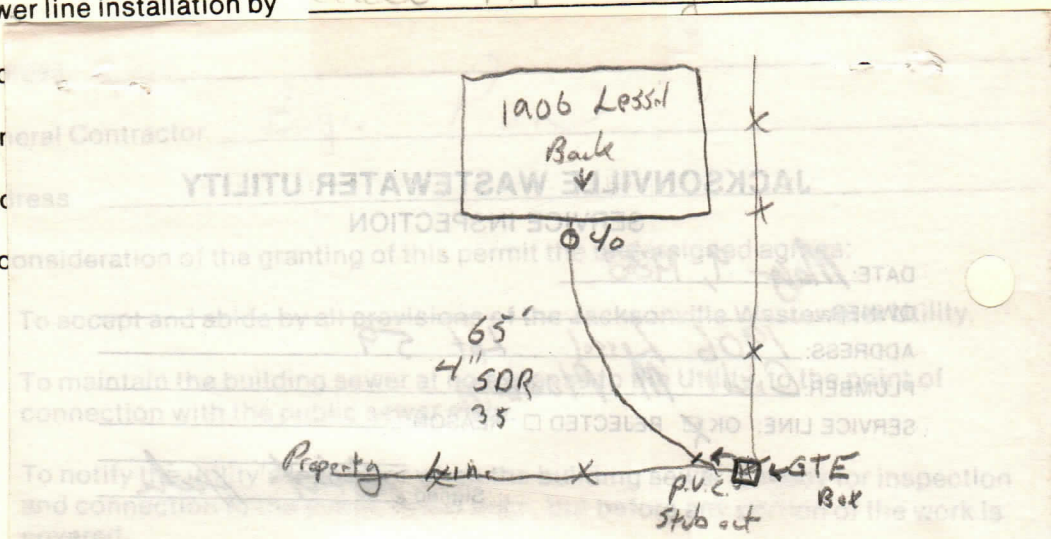

Fees: Connection Fee \$ 75.00
Tap Charge \$ _____
Inspection Fee \$ 6.00
Total Fees \$ 81.00

Receipt No. 13 3/24/88
Receipt No. _____
Receipt No. 77 5/19/88

APPLICANT

Signed _____

- ☐ Plumbing Contractor
☐ General Contract
☐ Owner (Address _____)

APPROVED

Jacksonville Wastewater Utility

By: Hissa ByardDate: 5/19/88