



No. 88-00045

JACKSONVILLE WASTEWATER UTILITY

RESIDENTIAL OR COMMERCIAL BUILDING SEWER CONNECTION PERMIT

Street Address 1907 Steeplechase DrLegal Description Lot 358 Phase VIII

Facility to be connected to sewer:

Single Family Residence ☒ *Multi-family Residential _____ Units _____*Commercial Installation _____ Description: ResWater Meter (s) size 3/8

*Commerical installations, and multi-family installations of more than 4 dwelling units must be accompanied by a site plan showing the proposed building sewer.

Sewer line installation by Hand

Address _____

General _____

Address _____

In cons: _____

1. To _____

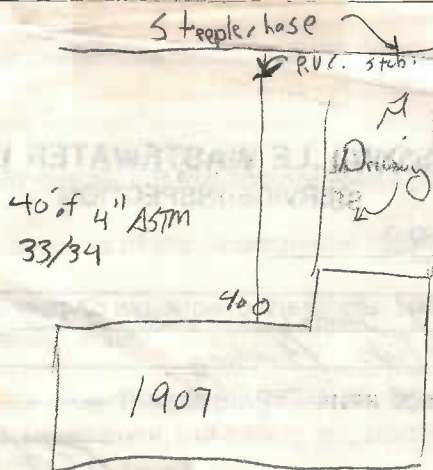
2. To
co _____3. To
an
co _____

Fees: Connection fee _____

Tap Charge \$ _____

Receipt No. _____

Inspection Fee \$ 6.00Receipt No. 107 5-24-88Total Fees \$ 81.00

APPLICANT

Signed Richard Schuler☐ Plumbing Contractor☐ General Contract☐ Owner (Address _____)

APPROVED

Jacksonville Wastewater Utility

By: HandDate: 5/25/88