

No 304

JACKSONVILLE WASTEWATER UTILITY

RESIDENTIAL OR COMMERCIAL BUILDING SEWER CONNECTION PERMIT

Street Address 1924 F WEST MAINLegal Description CARPENTER REALTY

Facility to be connected to sewer:

Single Family Residence _____ *Multi-family Residential _____ Units _____

*Commercial Installation ☒ Description: STAIN MFG. (NEW)Water Meter (s) size 3/4"

*Commerical installations, and multi-family installations of more than 4 dwelling units must be accompanied by a site plan showing the proposed building sewer.

Sewer line installation by CIRCLE "M" PLUMBING

Address _____

General _____

Address _____

In cons Main st. Carpenter Realty

1. To _____

2. To _____
com _____ Building GO SC STAND OUT3. To _____
and _____ Chicken Country _____
con _____Fees: Connection Fee \$ 75Receipt No. 1821 8-2-8

Tap Charge \$ _____

Receipt No. _____

Inspection Fee \$ 6.00Receipt No. 2294 5/23/96Total Fees \$ 81.00APPLICANT
Signed Multi-Party

- ☐ Plumbing Contractor
☐ General Contract
☒ Owner (Address _____)

APPROVED
Jacksonville Wastewater UtilityBy: Michael S. Sellers Date: 5/23/96



NO. 02- 000026

JACKSONVILLE WASTEWATER UTILITY

248 Cloverdale Road · P.O. Box 69
Jacksonville, AR 72078-0069
982-0581

RESIDENTIAL OR COMMERCIAL BUILDING SEWER CONNECTION PERMIT

Street Address 1924 W. Main

Legal Description _____

Facility to be connected to sewer:

Single Family Residence _____ *Multi-family Residential _____ Units _____

*Commercial Installation ✓ Description: replaced sewerWater Meter (s) Size 3/4

* Commercial installations, and multi-family installations of more than 4 dwelling units must be accompanied by a site plan showing the proposed building sewer.

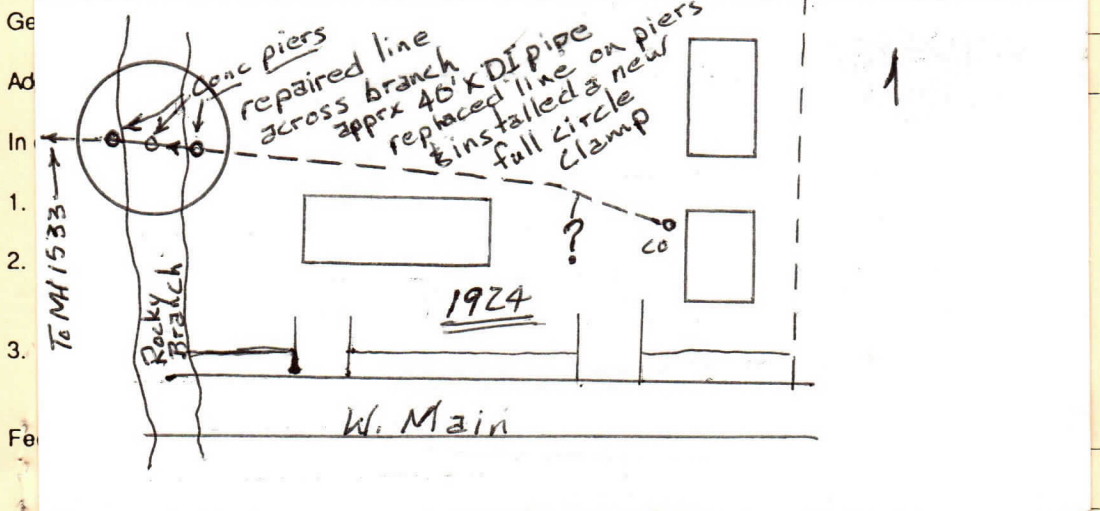
Sewer line installation by Carpenter Property Mgmt.Address John Kirby MP3590Inspection Fee \$ 6.00Receipt No. 9085

Street Cut \$ _____

Receipt No. _____

APPLICANT

Signed X [Signature]☒ Plumbing Contractor☐ General Contract☐ Owner (Address _____)

APPROVED

Jacksonville Wastewater Utility

By: Patricia Reed Date: 3-8-02



JACKSONVILLE WASTEWATER UTILITY

248 Cloverdale Road · P.O. Box 69
Jacksonville, AR 72078-0069
982-0581

No. 05-0302

RESIDENTIAL OR COMMERCIAL BUILDING SEWER CONNECTION PERMIT

Street Address 1924 W. Main Street

Legal Description _____

Facility to be connected to sewer:

Single Family Residence _____ *Multi-family Residential _____ Units _____

*Commercial Installation ☒ Description: _____

Water Meter (s) Size _____

* Commercial installations, and multi-family installations of more than 4 dwelling units must be accompanied by a site plan showing the proposed building sewer.

Sewer line installation by Gibson Plumbing

Address _____

General Contractor _____

Address _____

In consideration of the granting of this permit the undersigned hereby agrees to:

1. To accept and abide by all provisions of the Jacksonville Wastewater Utility Ordinance.
2. To maintain the building sewer at no expense to the City of Jacksonville.
3. To notify the utility's inspector when the building sewer is ready for inspection, but before any portion of the building sewer is covered.

Fees: Connection Fee \$ _____

Tap Charge \$ _____

Inspection Fee \$ 12.00

Street Cut \$ _____

APPLICANT

Signed [Signature]

- ☐ Plumbing Contractor
☐ General Contractor
☒ Owner (Address 21 Serv
NIK, NIK)

APPROVED
Jacksonville Wastewater Utility

By: [Signature] Date: 31 Oct. 05

