



JACKSONVILLE WASTEWATER UTILITY

248 Cloverdale Rd.
Jacksonville, AR 72076
501-982-0581

No. 12- **0275**

RESIDENTIAL OR COMMERCIAL BUILDING SEWER CONNECTION PERMIT

Address 2012 Airborne Drive

Description Lot 238, Brice Meadows Ph. 4

to be connected to sewer:

Family Residence _____ Multi-family Residential _____ Units _____

Commercial Installation _____ Description: New Connection

Sanitary Meter (s) Size 18

Commercial installations, and multi-family installations of more than 4 dwelling units must be accompanied by a site plan showing the proposed building sewer.

Sanitary line installation by Celshore Plumbing

Inspector _____

General Contractor Relaxed Custom Homes

Inspector PO Box 771 Calver, AR 72025

Consideration of the granting of this permit the undersigned agrees:

to accept and abide by all provisions of the Jacksonville Wastewater Utility.

to maintain the building sewer at no expense to the Utility, to the point of connection with the public sewer main.

to notify the utility's inspector when the building sewer is ready for inspection and connection to the public sewer main, but before any portion of the work is covered.

Connection Fee \$ 7500 11/21/12 Receipt No. 390352

Tap Charge \$ _____ Receipt No. _____

Inspection Fee \$ 2500 1/24/13 Receipt No. on audit

Street Cut \$ _____ Receipt No. _____

APPLICANT [Signature]

- ☐ Plumbing Contractor
- ☐ General Contract
- ☐ Owner (Address Hesley 1/23/13)

complete
1/24/13

APPROVED
Jacksonville Wastewater Utility

Date: 11-13-12

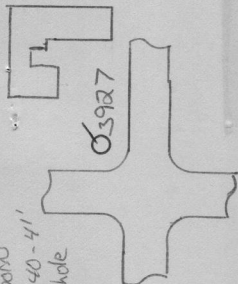

2012 Airborne
4 ft sch 40-4"
Tap Manhole
#3927

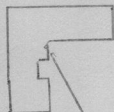

2012 Airborne Dr.
65 ft sch 40-4"
Ties into #3927

11/4 3927