



# JACKSONVILLE WASTEWATER UTILITY

248 Cloverdale Rd.  
Jacksonville, AR 72076  
501-982-0581

No. 10-0000248

## RESIDENTIAL OR COMMERCIAL BUILDING SEWER CONNECTION PERMIT

Street Address 2017 Remick

Legal Description 8195 Base meadow Sub

Facility to be connected to sewer:

Single Family Residence X \*Multi-family Residential          Units         

\*Commercial Installation          Description: New Connection

Water Meter (s) Size 5/8"

\* Commercial installations, and multi-family installations of more than 4 dwelling units must be accompanied by a site plan showing the proposed building sewer.

Sewer line installation by John Martin Plmng

Address         

General Contractor Chris Nelson

Address 1111 Division Dr. Jacksonville, AR

In consid

1. To ac

2. To ma  
public

3. To not  
to the

Fees:

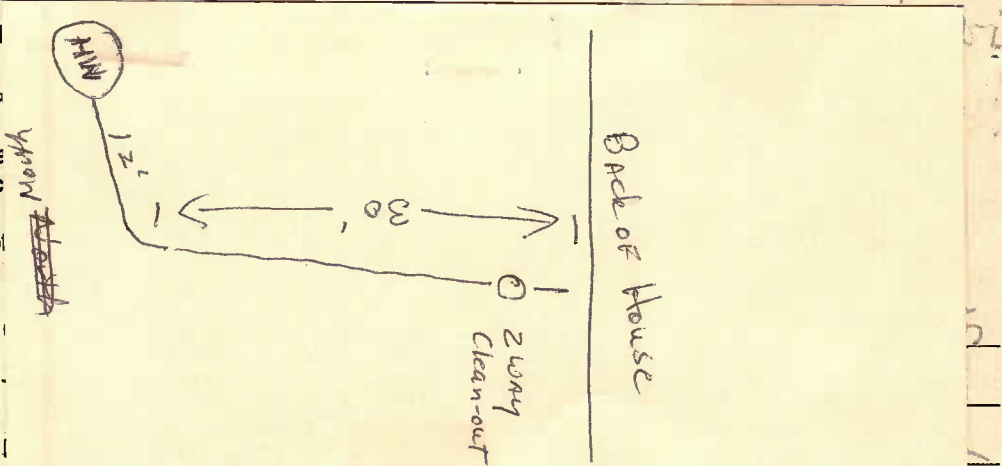

Street Cut \$         

Receipt No.         

APPLICANT

Signed AD Wh

☐ Plumbing Contractor

☒ General Contract

☐ Owner (Address         )

APPROVED

Jacksonville Wastewater Utility

By: [Signature] Date: 10/22/10

Complete  
2/14/11