



JACKSONVILLE WASTEWATER UTILITY

0159

RESIDENTIAL OR COMMERCIAL BUILDING SEWER CONNECTION PERMIT

Street Address 203 Chestnut

Legal Description Lot 14 Heatherwood

Facility to be connected to sewer:

Single Family Residence _____ * Multi-family Residential ☒ Units 2

* Commercial Installation _____ Description: New (one of two units)

Water Meter (s) size 3/4"

* Commerical installations, and multi-family installations of more than 4 dwelling units must be accompanied by a site plan showing the proposed building sewer.

Sewer line installation by STEVE BIRKSHIRE

Address _____

General C _____

Address _____

In consid _____

1. To acc _____

2. To ma
conne _____

3. To not
and co
cover _____

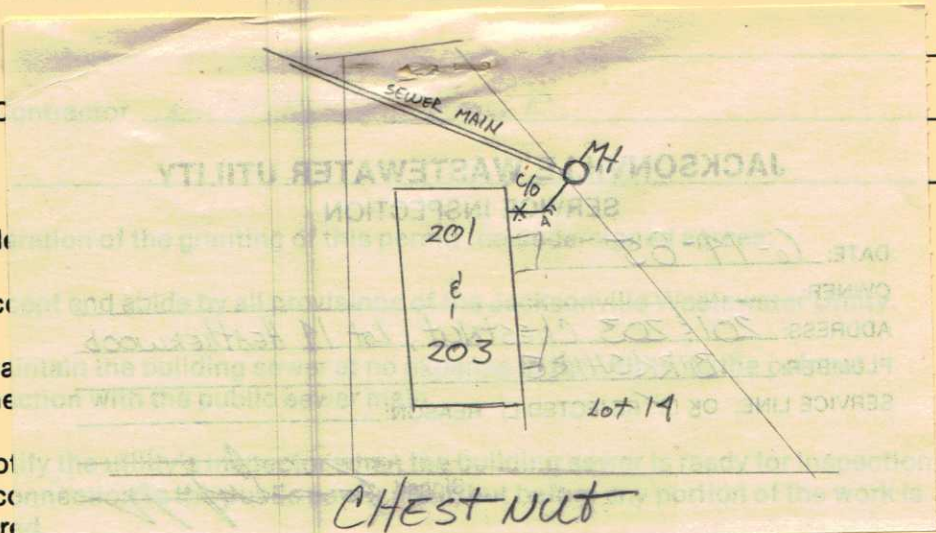

Fees:	Connection Fee	\$ <u>75.00</u>	Receipt No. <u>1562</u> 1-10-85
	Tap Charge	\$ _____	Receipt No. _____
	Inspection Fee	\$ <u>6.00</u>	Receipt No. <u>1740</u> 6-10-85
	Total Fees	\$ <u>81.00</u>	

APPLICANT
Signed Steve Birkshire

- ☐ Plumbing Contractor
☐ General Contract
☐ Owner (Address _____)

APPROVED
Jacksonville Wastewater Utility

By: Kim Cuppen Date: 6-10-85