



No. 01241

JACKSONVILLE WASTEWATER UTILITY

248 Cloverdale Road · P.O. Box 69
Jacksonville, AR 72078-0069
982-0581

RESIDENTIAL OR COMMERCIAL BUILDING SEWER CONNECTION PERMIT

Street Address 204 Hilda

Legal Description _____

Facility to be connected to sewer:

Single Family Residence ☒ *Multi-family Residential _____ Units _____*Commercial Installation _____ Description: Street cutWater Meter (s) Size 5 1/2"

* Commercial installations, and multi-family installations of more than 4 dwelling units must be accompanied by a site plan showing the proposed building sewer.

Sewer line installation by AAA Plumbing

Address

General

Address

In case

1. To

2. To

P

3. To

to

Feet

Feet

APF

Sign

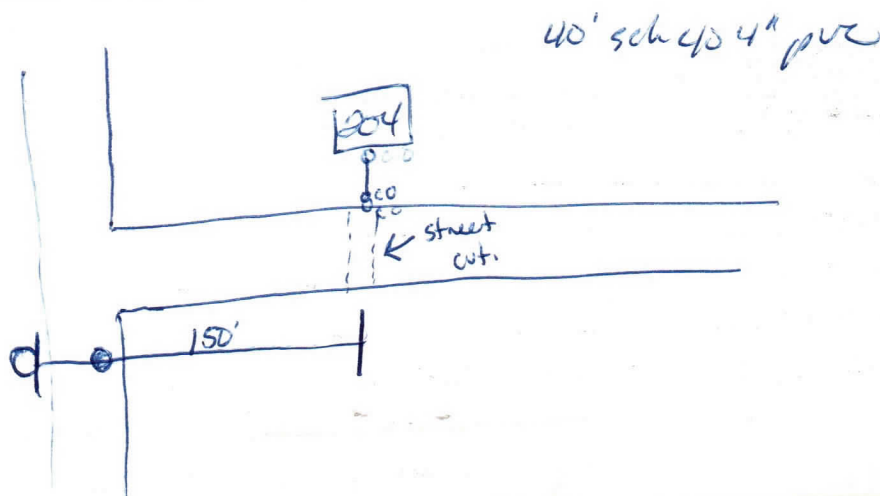
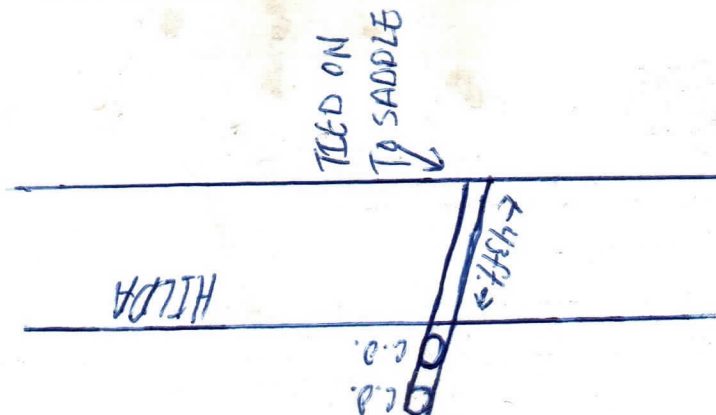
APPROVED
Jacksonville Wastewater UtilityBy: Patricia ReedDate: 10-1-01