



JACKSONVILLE WASTEWATER UTILITY
248 Cloverdale Rd.
Jacksonville, AR 72076
501-982-0581

No. 14- 0123

RESIDENTIAL OR COMMERCIAL BUILDING SEWER CONNECTION PERMIT

Street Address 204 Marble Drive
Legal Description Lot 11, Stoneridge, Ph. I

Facility to be connected to sewer:

Single Family Residence _____ *Multi-family Residential _____ Units _____

*Commercial Installation 5/8 Description: New Connection

Water Meter (s) Size _____

* Commercial installations, and multi-family installations of more than 4 dwelling units must be accompanied by a site plan showing the proposed building sewer.

Sewer line installation by Mulligan Plmng

Address _____

General Contractor _____

Address _____

In consideration of _____

1. To accept _____

2. To maintain _____ public _____

3. To not _____ to the _____

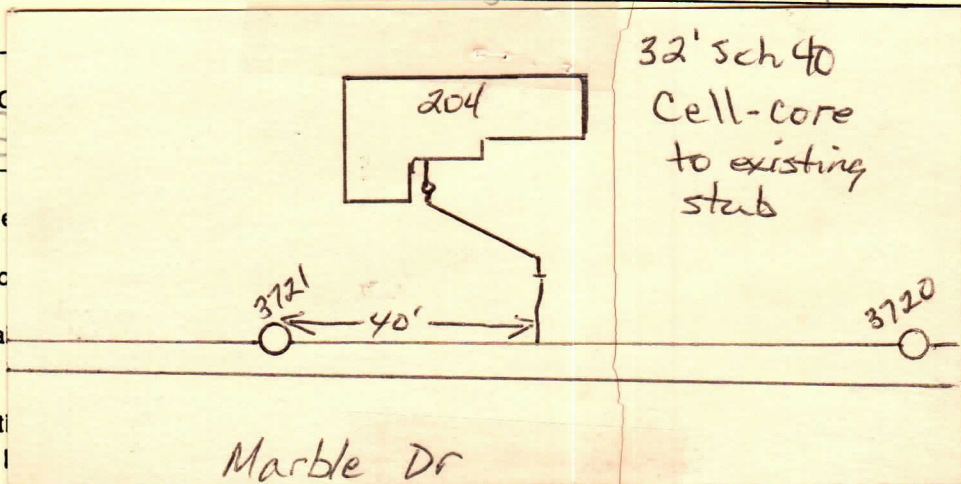

Fees: Connection Fee \$ 1500 7/19/14

Tap Charge \$ _____

Inspection Fee \$ 2500 6/25/14

Street Cut \$ _____

Receipt No. 815062

Receipt No. _____

Receipt No. on acct

Receipt No. _____

APPLICANT Signed Seymour Underwood 912-0642

☐ Plumbing Contractor

☐ General Contract

☐ Owner (Address _____)

APPROVED
Jacksonville Wastewater Utility

By: [Signature] Date: 4.7.14

CHH 3928

complete
6/25/14
[Signature]