



No. 99 0495

# JACKSONVILLE WASTEWATER UTILITY

248 Cloverdale Road • P.O. Box 69  
Jacksonville, AR 72078-0069  
982-0581

## RESIDENTIAL OR COMMERCIAL BUILDING SEWER CONNECTION PERMIT

Street Address 204 N. James St.

Legal Description \_\_\_\_\_

Facility to be connected to sewer:

Single Family Residence \_\_\_\_\_ \*Multi-family Residential \_\_\_\_\_ Units \_\_\_\_\_

\*Commercial Installation \_\_\_\_\_ Description: sewer

Water Meter (s) Size \_\_\_\_\_

\* Commercial installations, and multi-family installations of more than 4 dwelling units must be accompanied by a site plan showing the proposed building sewer.

Sewer line installation by AAA Plumbing

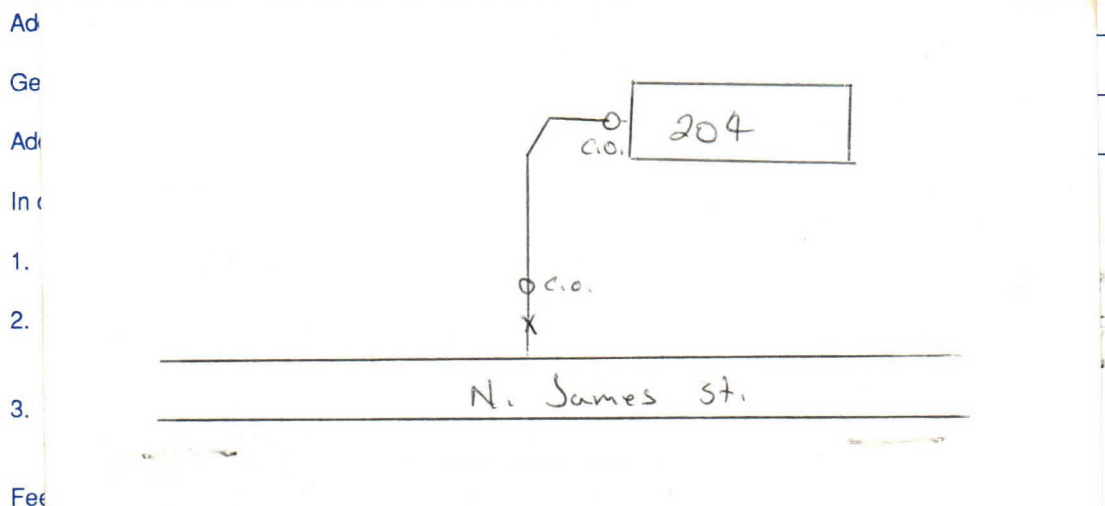

Tap Charge \$ \_\_\_\_\_

Receipt No. \_\_\_\_\_

Inspection Fee \$ 17.50

Receipt No. 99-0495

Total Fees \$ \_\_\_\_\_

### APPLICANT

Signed \_\_\_\_\_

☐ Plumbing Contractor

☐ General Contract

☐ Owner (Address \_\_\_\_\_)

### APPROVED

Jacksonville Wastewater Utility

By: Linda Luman Date: 11/17/09



No. 00 0028

**JACKSONVILLE WASTEWATER UTILITY**248 Cloverdale Road • P.O. Box 69  
Jacksonville, AR 72078-0069  
982-0581**RESIDENTIAL OR COMMERCIAL BUILDING SEWER CONNECTION PERMIT**Street Address 204 N James

Legal Description \_\_\_\_\_

Facility to be connected to sewer:

Single Family Residence ☒ \*Multi-family Residential \_\_\_\_\_ Units \_\_\_\_\_\*Commercial Installation \_\_\_\_\_ Description: keptWater Meter (s) Size 5/8

\* Commercial installations, and multi-family installations of more than 4 dwelling units must be accompanied by a site plan showing the proposed building sewer.

Sewer line installation by AAA Plumbing

Address \_\_\_\_\_

General \_\_\_\_\_

Address \_\_\_\_\_

In connection with \_\_\_\_\_

1. To \_\_\_\_\_

2. To \_\_\_\_\_  
pu \_\_\_\_\_3. To \_\_\_\_\_  
to \_\_\_\_\_

Fees:

Tap Charge \$ \_\_\_\_\_

Inspection Fee \$ 600

Total Fees \$ \_\_\_\_\_

Receipt No. \_\_\_\_\_

Receipt No. 7750**APPLICANT**Signed Per phone message☐ Plumbing Contractor☐ General Contract☐ Owner (Address \_\_\_\_\_)**APPROVED**

Jacksonville Wastewater Utility

By: [Signature] Date: 2/10/00

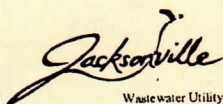

JACKSONVILLE WASTEWATER UTILITY  
248 Cloverdale Rd.  
Jacksonville, AR 72076  
501-982-0581

No. 10-0000333

## RESIDENTIAL OR COMMERCIAL BUILDING SEWER CONNECTION PERMIT

Street Address 204B N. James St

Legal Description \_\_\_\_\_

Facility to be connected to sewer:

Single Family Residence \_\_\_\_\_ \*Multi-family Residential \_\_\_\_\_ Units \_\_\_\_\_

\*Commercial Installation \_\_\_\_\_ Description: Replacement

Water Meter (s) Size \_\_\_\_\_

\* Commercial installations, and multi-family installations of more than 4 dwelling units must be accompanied by a site plan showing the proposed building sewer.

Sewer line Installation by RRH Plumbing Rick 419-151-3980

Address 20' sch 40

General Co PVC

Address \_\_\_\_\_

In consideration of \_\_\_\_\_

1. To accept \_\_\_\_\_

2. To maintain public sewer \_\_\_\_\_

3. To notify to the public \_\_\_\_\_

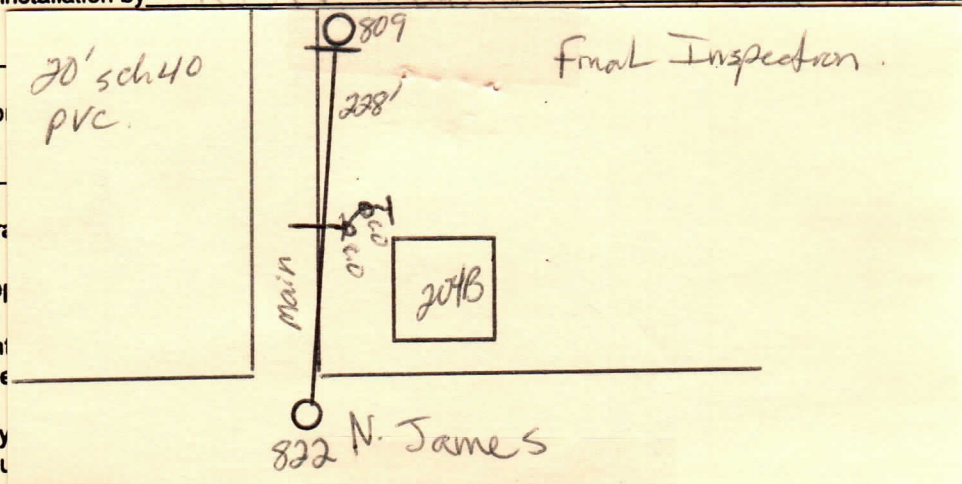

Fees: Connection Fee \$ \_\_\_\_\_ Receipt No. \_\_\_\_\_

Tap Charge \$ \_\_\_\_\_ Receipt No. \_\_\_\_\_

Inspection Fee \$ 2500 Receipt No. 241127

Street Cut \$ \_\_\_\_\_ Receipt No. \_\_\_\_\_

APPLICANT Signed Richard [Signature]

☐ Plumbing Contractor

☐ General Contract

☐ Owner (Address \_\_\_\_\_)

APPROVED Jacksonville Wastewater Utility

By: Richard [Signature] Date: 1/14/11

Complete  
1/14/11