



JACKSONVILLE WASTEWATER UTILITY  
248 Cloverdale Rd.  
Jacksonville, AR 72076  
501-982-0581

No. 14- 0124

### RESIDENTIAL OR COMMERCIAL BUILDING SEWER CONNECTION PERMIT

Street Address 206 Marble Drive  
Legal Description LOT 12, Stoveridge Ph I.

Facility to be connected to sewer:

Single Family Residence \_\_\_\_\_ \*Multi-family Residential \_\_\_\_\_ Units \_\_\_\_\_

\*Commercial Installation \_\_\_\_\_ Description: New Connection

Water Meter (s) Size 5/8

\* Commercial installations, and multi-family installations of more than 4 dwelling units must be accompanied by a site plan showing the proposed building sewer.

Sewer line installation by Mulligan Plumbing

Address \_\_\_\_\_

General \_\_\_\_\_

Address \_\_\_\_\_

In consid \_\_\_\_\_

1. To ac \_\_\_\_\_

2. To ma \_\_\_\_\_  
public \_\_\_\_\_

3. To not \_\_\_\_\_  
to the \_\_\_\_\_

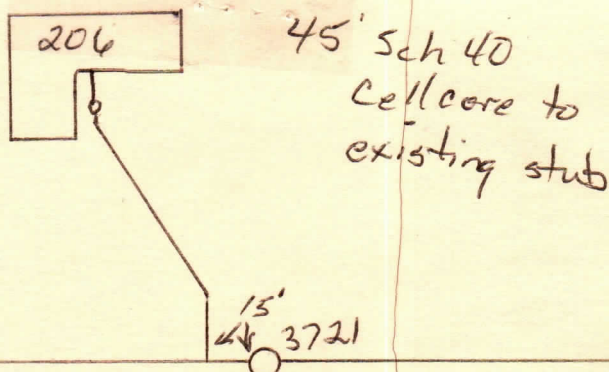

Fees: Connection Fee \$ 1500

Tap Charge \$ \_\_\_\_\_

Inspection Fee \$ 2500

Street Cut \$ \_\_\_\_\_

Receipt No. 875062

Receipt No. \_\_\_\_\_

Receipt No. on auct

Receipt No. \_\_\_\_\_

APPLICANT Signed Slynn Underwood 912-0642

☐ Plumbing Contractor

☐ General Contract

☐ Owner (Address \_\_\_\_\_)

APPROVED  
Jacksonville Wastewater Utility

By: [Signature] Date: 4.7.14

CH 3928

complete  
6/25/14