



No. 99 0050

**JACKSONVILLE WASTEWATER UTILITY**248 Cloverdale Road • P.O. Box 69  
Jacksonville, AR 72078-0069  
982-0581**RESIDENTIAL OR COMMERCIAL BUILDING SEWER CONNECTION PERMIT**Street Address 206 Otter PlaceLegal Description lot 108 Northlake Subd Phase II

Facility to be connected to sewer:

Single Family Residence ✓ \*Multi-family Residential \_\_\_\_\_ Units \_\_\_\_\_

\*Commercial Installation \_\_\_\_\_ Description: \_\_\_\_\_

Water Meter (s) Size 5/8

\* Commercial installations, and multi-family installations of more than 4 dwelling units must be accompanied by a site plan showing the proposed building sewer.

Sewer line installation by A-1

Address \_\_\_\_\_

General

Address \_\_\_\_\_

In consid

1. To ac

2. To m  
publi3. To ne  
to the

Fees:

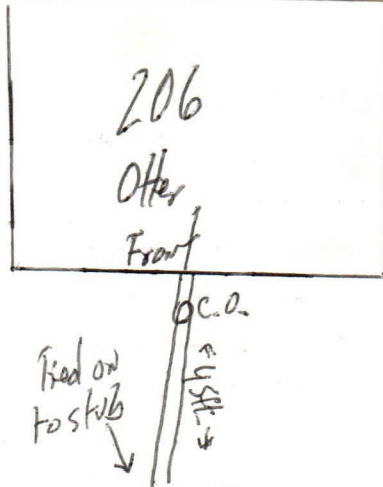
Inspection Fee \$ 6.00 52677 Receipt No. 7201Total Fees \$ 75.00

APPLICANT

Signed Debra Camp☐ Plumbing Contractor☐ General Contract☐ Owner (Address \_\_\_\_\_)

APPROVED

Jacksonville Wastewater Utility

By: Swan Smith Date: 3-29-99