



JACKSONVILLE WASTEWATER UTILITY

0161

RESIDENTIAL OR COMMERCIAL BUILDING SEWER CONNECTION PERMIT

Street Address 207 Chestnut

Legal Description Lot 15 Heatherwood

Facility to be connected to sewer:

Single Family Residence _____ *Multi-family Residential ☒ Units 2

*Commercial Installation _____ Description: NEW (ONE OF TWO UNITS)

Water Meter (s) size 3/4"

*Commerical installations, and multi-family installations of more than 4 dwelling units must be accompanied by a site plan showing the proposed building sewer.

Sewer line installation by STEVE BIRKSHIRE

Address _____

General Co _____

Address _____

In consider _____

1. To acc ty.
2. To main
conn ction
3. To noti
and cor
cover rk is

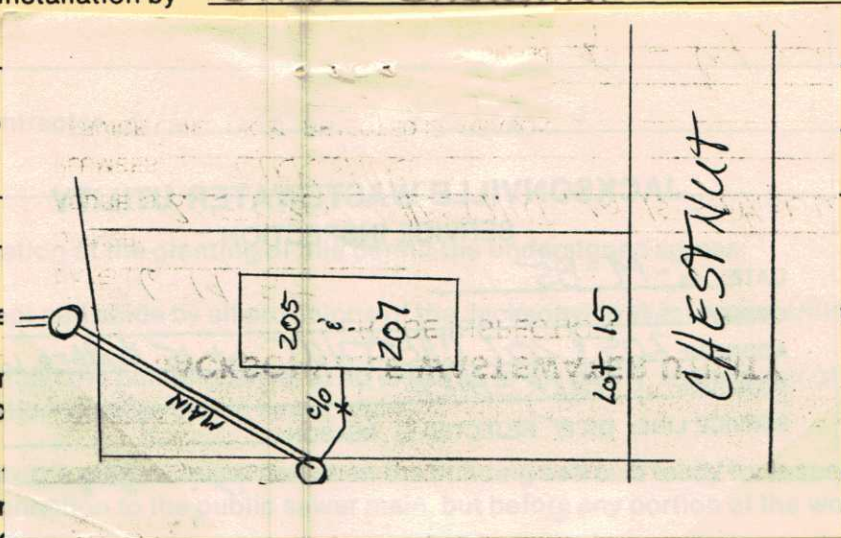

Fees:	Connection Fee	\$ <u>75.00</u>	Receipt No. <u>1562</u> 1-10-85
	Tap Charge	\$ _____	Receipt No. _____
	Inspection Fee	\$ _____	Receipt No. <u>1740</u>
	Total Fees	\$ <u>6.00</u>	

APPLICANT Signed [Signature]

- ☐ Plumbing Contractor
☐ General Contract
☐ Owner (Address _____)

APPROVED
Jacksonville Wastewater Utility

By: [Signature] Date: 6-10-85