

No. 12-0013



JACKSONVILLE WASTEWATER UTILITY
 248 Cloverdale Rd.
 Jacksonville, AR 72076
 501-982-0581

RESIDENTIAL OR COMMERCIAL BUILDING SEWER CONNECTION PERMIT

Street Address 208 Heritage

Legal Description _____

Facility to be connected to sewer:

Single Family Residence ☒ *Multi-family Residential _____ Units _____

*Commercial Installation _____ Description: Sewer Replacement

Water Meter (s) Size 5/8"

* Commercial installations, and multi-family installations of more than 4 dwelling units must be accompanied by a site plan showing the proposed building sewer.

Sewer line installation by WWT Cody

Address _____

General _____

Address _____

In con _____

1. To _____

2. To put _____

3. To to t _____



PERMIT NO. 12-0013

JACKSONVILLE WASTEWATER UTILITY
 SERVICE INSPECTION

DATE: 1-31-12

OWNER: _____

ADDRESS: 208 Heritage St.

PLUMBER: Twinn

SERVICE LINE: OK ☒ REJECTED ☐ REASON: _____

SIGNED: [Signature]

Fees: Connection Fee \$ _____

Tap Charge \$ _____

Inspection Fee \$ 0

Street Cut \$ _____

Receipt No. _____

Receipt No. _____

Receipt No. no charge

Receipt No. _____

APPLICANT

Signed N/A

☐ Plumbing Contractor

☐ General Contract

☐ Owner (Address _____)

APPROVED

Jacksonville Wastewater Utility

By: [Signature] Date: 1/31/12

Complete
1/31/12

Heritage St.

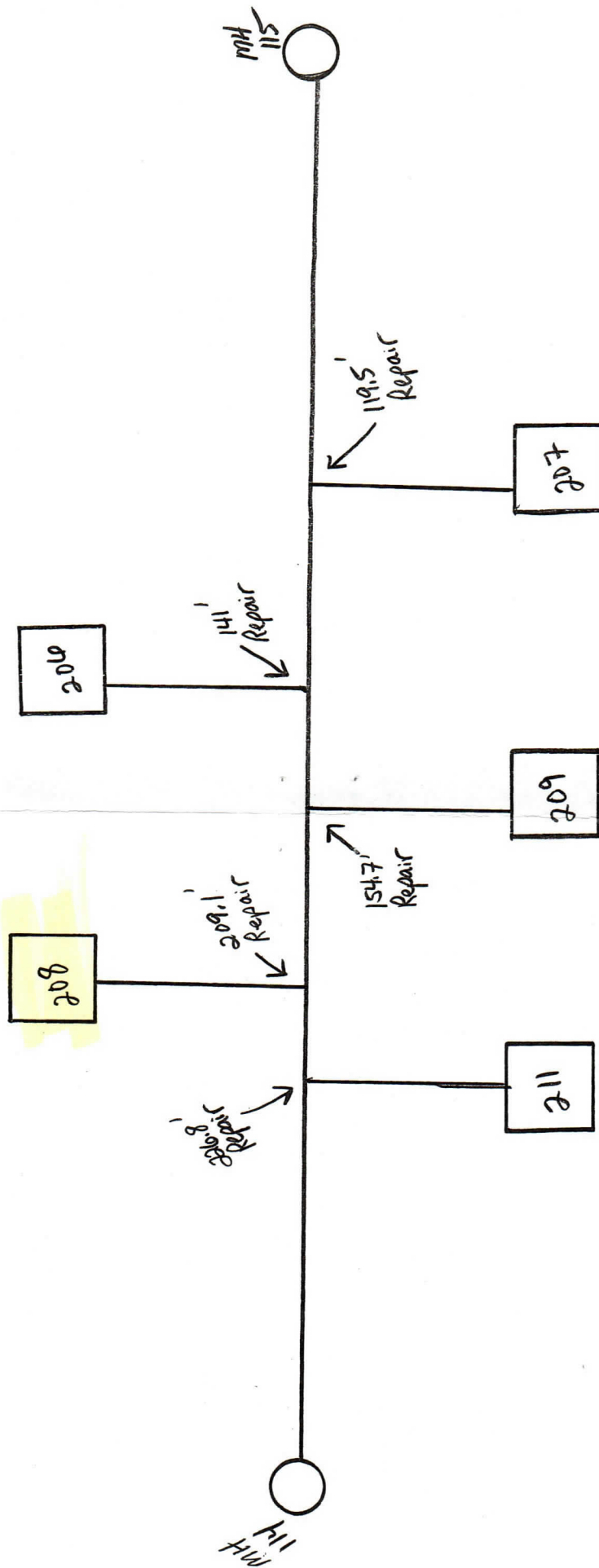

N. Eastern St.