



JACKSONVILLE WASTEWATER UTILITY
248 Cloverdale Rd.
Jacksonville, AR 72076
501-982-0581

No. 22- 0139

RESIDENTIAL OR COMMERCIAL BUILDING SEWER CONNECTION PERMIT

Street Address 208 Meadows Dr

Legal Description Lot 44 Meadows Sub.

Facility to be connected to sewer:

Single Family Residence ☒ *Multi-family Residential ☐ Units ☐

*Commercial Installation ☐ Description: New Connection

Water Meter (s) Size 5/8"

* Commercial installations, and multi-family installations of more than 4 dwelling units must be accompanied by a site plan showing the proposed building sewer.

Sewer line installation by Jackson Plumber's

Address _____

General Contract _____

Address _____

In consideration of _____

1. To accept _____

2. To maintain _____
public _____

3. To notify _____
to the _____

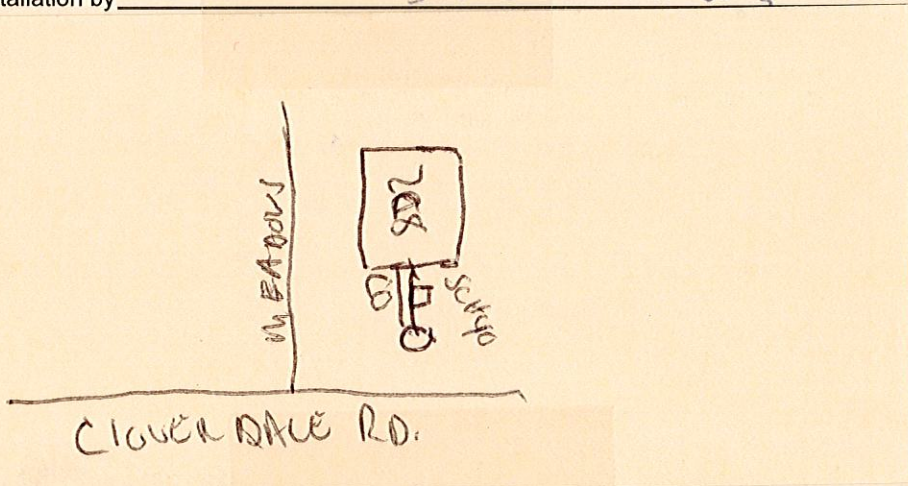

Fee: Connection Fee \$ 75.00 6/14/2022 Receipt No. 802477

Tap Charge \$ _____ Receipt No. _____

Inspection Fee \$ 25.00 4/12/23 Receipt No. 522105

Street Cut \$ _____ Receipt No. _____

APPLICANT
Signed Lea

☐ Plumbing Contractor

☐ General Contract

☐ Owner (Address _____)

Mike

complete
4/13/23

APPROVED
Jacksonville Wastewater Utility

By: MFB Date: 6.8.22