



**JACKSONVILLE WASTEWATER UTILITY**  
248 Cloverdale Rd.  
Jacksonville, AR 72076  
501-982-0581

No. 24- 0118

**RESIDENTIAL OR COMMERCIAL BUILDING SEWER CONNECTION PERMIT**

Street Address 2101 Woodhaven Dr  
Legal Description New Connection Lot 10 Foxwood Gardens

Facility to be connected to sewer:

Single Family Residence ✓ \*Multi-family Residential \_\_\_\_\_ Units \_\_\_\_\_  
\*Commercial Installation \_\_\_\_\_ Description: New Connection

Water Meter (s) Size 5/8

\* Commercial installations, and multi-family installations of more than 4 dwelling units must be accompanied by a site plan showing the proposed building sewer.

Sewer line installation by Westlake Plumbing

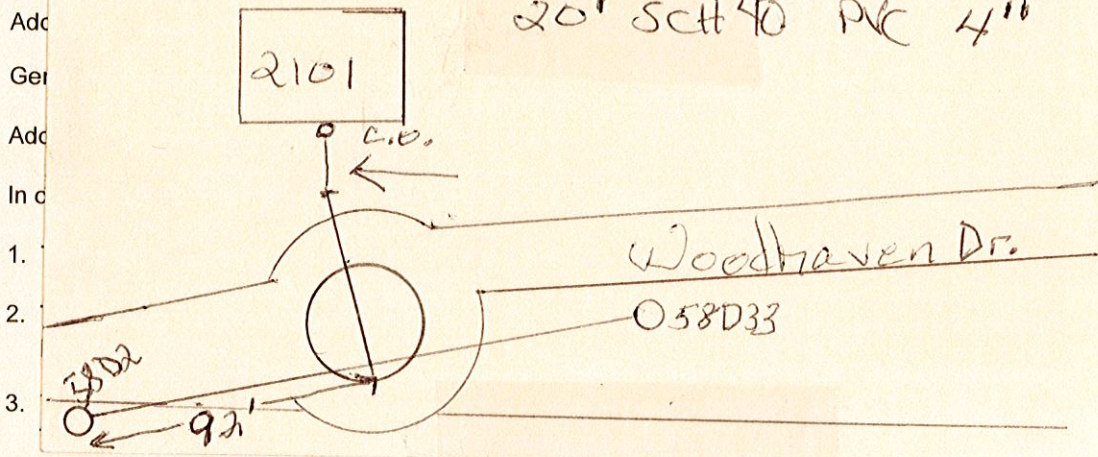

Fee:	Connection Fee	\$ <u>75.00</u>	Receipt No. <u>312568</u>
	Tap Charge	\$ _____	Receipt No. _____
	Inspection Fee	\$ <u>25.00</u>	11/14/2025 Receipt No. <u>onacet</u>
	Street Cut	\$ _____	Receipt No. _____

**APPLICANT**

Signed [Signature]  
☐ Plumbing Contractor  
☐ General Contract  
☐ Owner (Address \_\_\_\_\_)  
Complete 11/16/2025

**APPROVED**  
Jacksonville Wastewater Utility

By: [Signature] Date: 11/5/2024