



No. 88-00035

JACKSONVILLE WASTEWATER UTILITY

RESIDENTIAL OR COMMERCIAL BUILDING SEWER CONNECTION PERMIT

Street Address _____

Legal Description _____

Facility to be connected to sewer:

Single Family Residence _____ *Multi-family Residential _____ Units _____

*Commercial Installation _____ Description: _____

Water Meter (s) size _____

*Commerical installations, and multi-family installations of more than 4 dwelling units must be accompanied by a site plan showing the proposed building sewer.

Sewer line installation by _____

Address _____

General _____

Address _____

In consid _____

1. To ac _____

2. To m
conn _____

3. To n
and c
cove _____

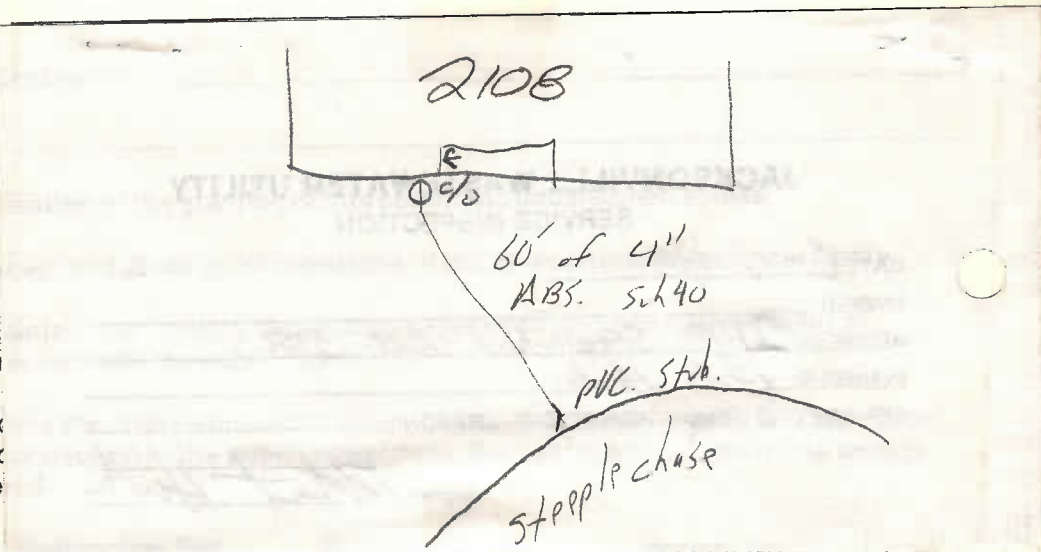

Fees:

Tap Charge \$ _____

Inspection Fee \$ 6.00

Total Fees \$ 81.00

Receipt No. _____

Receipt No. _____

Receipt No. 101 5-19-88

APPLICANT

Signed _____

☐ Plumbing Contractor

☐ General Contract

☐ Owner (Address _____)

APPROVED
Jacksonville Wastewater Utility

By: Steve Byrd

Date: 5/17/88