



No. 88-00024

JACKSONVILLE WASTEWATER UTILITY

RESIDENTIAL OR COMMERCIAL BUILDING SEWER CONNECTION PERMIT

Street Address 2309 Linda Lane

Legal Description _____

Facility to be connected to sewer:

Single Family Residence _____ * Multi-family Residential _____ Units _____

* Commercial Installation _____ Description: Replacement

Water Meter (s) size 5/8"

* Commerical installations, and multi-family installations of more than 4 dwelling units must be accompanied by a site plan showing the proposed building sewer.

Sewer line installation by Britt's Plow

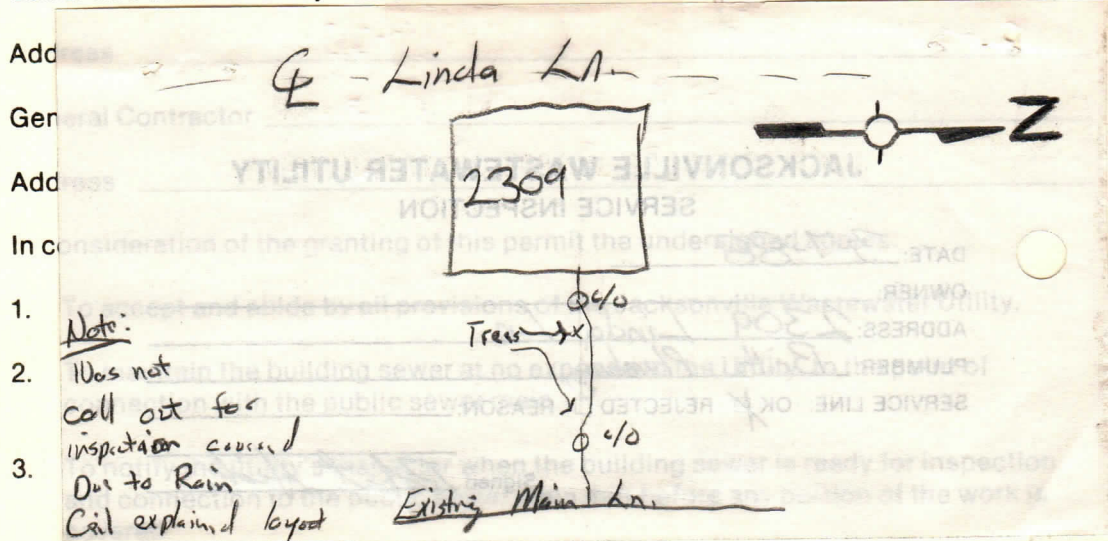

Fees:	Connection Fee	\$ _____
	Tap Charge	\$ <u>20.40</u>
	Inspection Fee	\$ <u>1.00</u>
	Total Fees	\$ <u>36.40</u>

Receipt No. _____
Receipt No. <u>3164 3/7/88</u>
Receipt No. <u>3164 3/7/88</u>

APPLICANT Signed Cecil Buttan

- ☐ Plumbing Contractor
- ☐ General Contract
- ☐ Owner (Address _____)

APPROVED
Jacksonville Wastewater Utility

By: M. Bellan Date: 3/7/88