



JACKSONVILLE WASTEWATER UTILITY
248 Cloverdale Rd.
Jacksonville, AR 72076
501-982-0581

No. 17-198

SLD

RESIDENTIAL OR COMMERCIAL BUILDING SEWER CONNECTION PERMIT

Street Address 231 Lonsdale Circle

Legal Description _____

Facility to be connected to sewer:

Single Family Residence ☒ *Multi-family Residential _____ Units _____

*Commercial Installation _____ Description: Tap / Replacement

Water Meter (s) Size 5/8

* Commercial installations, and multi-family installations of more than 4 dwelling units must be accompanied by a site plan showing the proposed building sewer.

Sewer line installation by Charles Plumbing - 773-3091

I, the undersigned agrees:

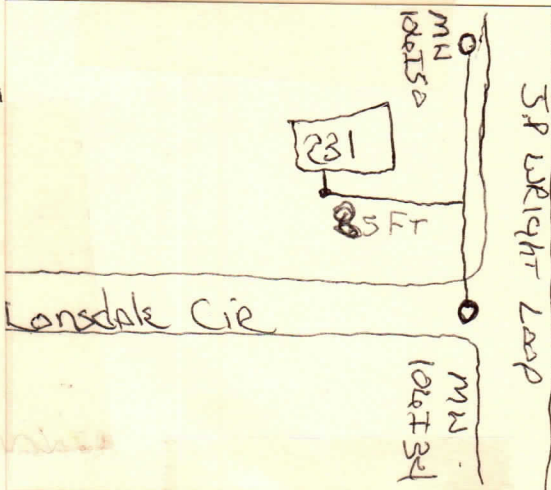
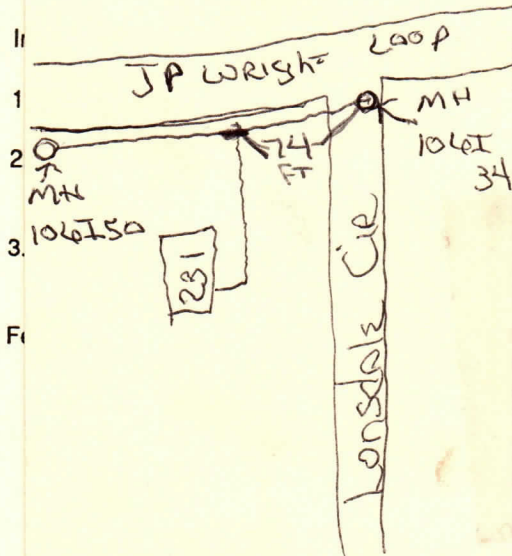

APPROVED
Jacksonville Wastewater Utility

By: [Signature] Date: 12/12/17

Tap complete
12/12/17

complete
12/12/17