



JACKSONVILLE WASTEWATER UTILITY

248 Cloverdale Rd.
Jacksonville, AR 72076
501-982-0581

No. 19- 0064

RESIDENTIAL OR COMMERCIAL BUILDING SEWER CONNECTION PERMIT

Street Address 2400 Linda Lane

Legal Description (old Jxville High Sch)

Facility to be connected to sewer:

Single Family Residence _____ *Multi-family Residential _____ Units _____

*Commercial Installation ☒ Description: Capped sewer

Water Meter (s) Size 5/8

* Commercial installations, and multi-family installations of more than 4 dwelling units must be accompanied by a site plan showing the proposed building sewer.

Sewer line installation by Roberts Hubbin - Ron 870-692-0852

Address _____

General C _____

Address _____

In consid _____

1. To acc _____

2. To ma public _____

3. To no to the _____ on

Fee: Connection Fee \$ _____ Receipt No. _____

Tap Charge \$ _____ Receipt No. _____

Inspection Fee \$ 25.00 Receipt No. 162186

Street Cut \$ _____ Receipt No. _____

APPLICANT Signed Ron Dray

- ☐ Plumbing Contractor
☐ General Contract
☐ Owner (Address _____)

Complete
8/15/19
WS

APPROVED
Jacksonville Wastewater Utility

By: [Signature] Date: 8/15/19



JACKSONVILLE WASTEWATER UTILITY
248 Cloverdale Rd.
Jacksonville, AR 72076
501-982-0581

No. 10-0000033

RESIDENTIAL OR COMMERCIAL BUILDING SEWER CONNECTION PERMIT

Street Address 2400 Linda Lane

Legal Description Jacksonville High School

Facility to be connected to sewer:

Single Family Residence _____ *Multi-family Residential _____ Units _____

*Commercial Installation ☒ Description: Replacement

Water Meter (s) Size 5/8

* Commercial installations, and multi-family installations of more than 4 dwelling units must be accompanied by a site plan showing the proposed building sewer.

Sewer line installation by Grady Kelly Plumbing

Address 701 Mission Rd N.E., AR 72118 MP 2411 4081-6476

General _____

Address _____

In consid _____

1. To acc _____

2. To ma _____

3. To no _____

to the _____

Fees: _____



No. 94- 086

JACKSONVILLE WASTEWATER UTILITY

248 Cloverdale Road • P.O. Box 69
Jacksonville, AR 72078-0069
982-0581

RESIDENTIAL OR COMMERCIAL BUILDING SEWER CONNECTION PERMITStreet Address 2400 Linda Ln. Jacksonville Hh School

Legal Description _____

Facility to be connected to sewer:

Single Family Residence _____ *Multi-family Residential _____ Units _____

*Commercial Installation ☒ Description: Repl.Water Meter (s) Size 4"

* Commercial installations, and multi-family installations of more than 4 dwelling units must be accompanied by a site plan showing the proposed building sewer.

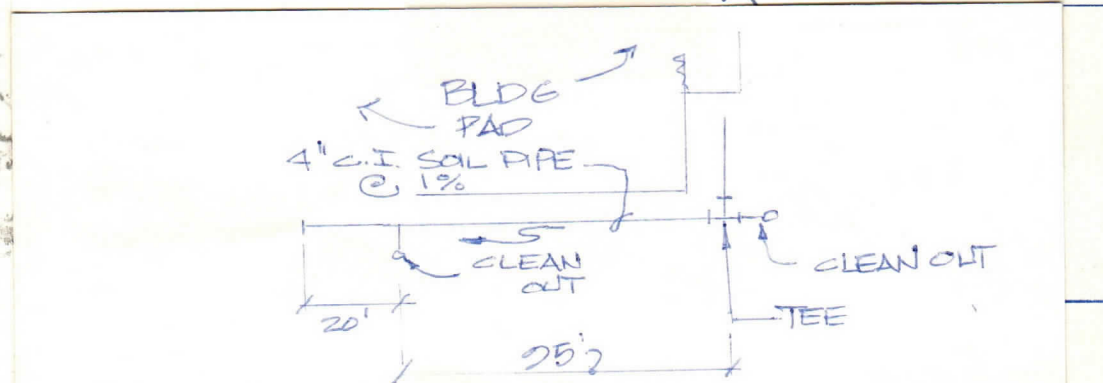
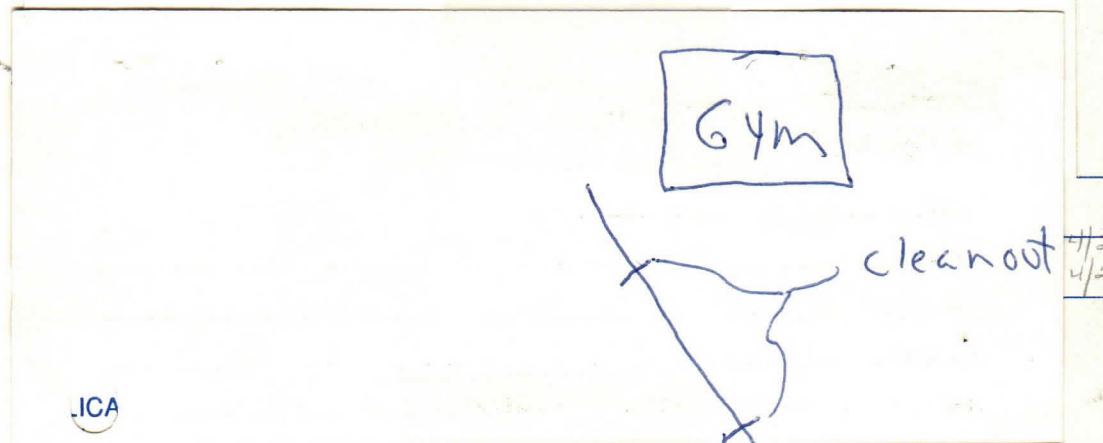
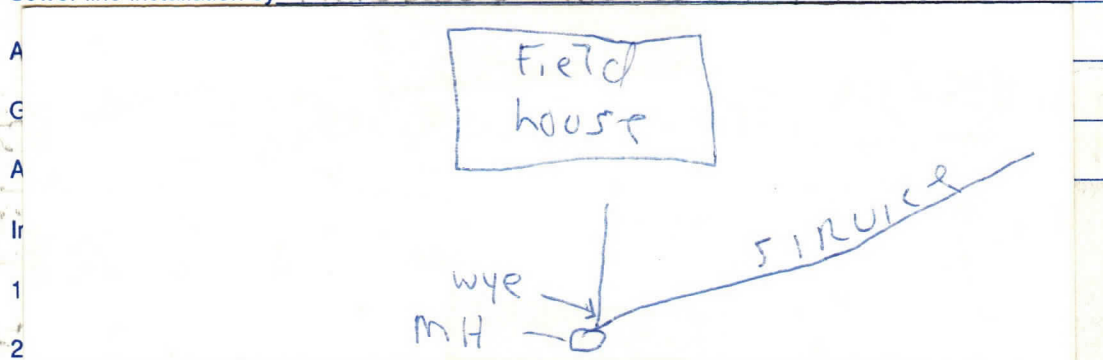
Sewer line installation by Kennedy Air Cond. & Plumb.

GYM