



No. 05-0289

JACKSONVILLE WASTEWATER UTILITY

248 Cloverdale Road • P.O. Box 69
Jacksonville, AR 72078-0069
982-0581

RESIDENTIAL OR COMMERCIAL BUILDING SEWER CONNECTION PERMITStreet Address 2404 Emily LaneLegal Description Lot 37 Clover Ridge Ph II

Facility to be connected to sewer:

Single Family Residence X *Multi-family Residential _____ Units _____

*Commercial Installation _____ Description: _____

Water Meter (s) Size _____

* Commercial installations, and multi-family installations of more than 4 dwelling units must be accompanied by a site plan showing the proposed building sewer.

Sewer line installation by Harden Plumb.

Address _____

General Contractor Camp ConstructionAddress PO Box 622 Jacksonville

In consideration of the granting of this permit the undersig

1. To accept and abide by all provisions of the Jacksonville
2. To maintain the building sewer at no expense to the U public sewer main.
3. To notify the utility's inspector when the building sewer to the public sewer main, but before any portion of the

Fees: Connection Fee \$ 75.00

Tap Charge \$ _____

Inspection Fee \$ 12.00

Street Cut \$ _____

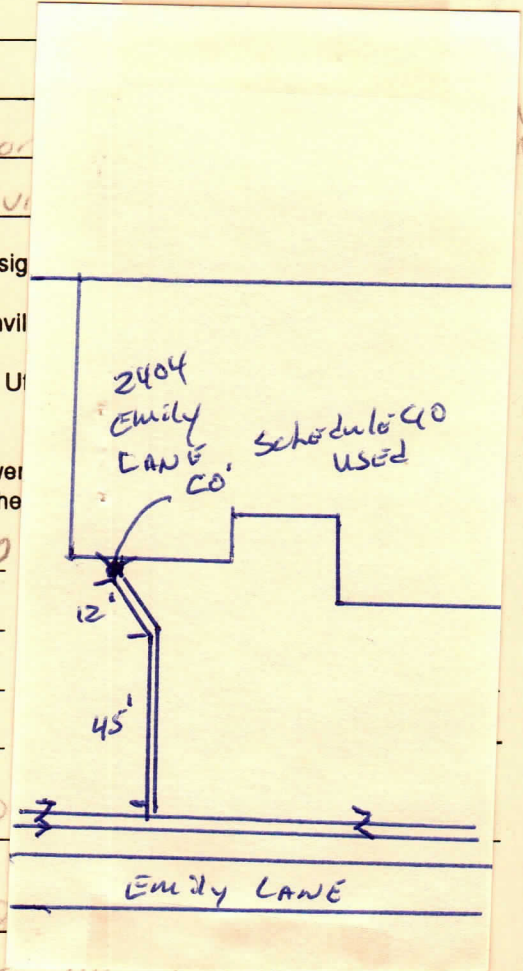
APPLICANTSigned Rebecca Camp☐ Plumbing Contractor☐ General Contract☐ Owner (Address P.O. Box 622**APPROVED**

Jacksonville Wastewater Utility

By: Mark Johnson Date: 9-30-05