



JACKSONVILLE WASTEWATER UTILITY
248 Cloverdale Rd.
Jacksonville, AR 72076
501-982-0581

No. 14- 0032

RESIDENTIAL OR COMMERCIAL BUILDING SEWER CONNECTION PERMIT

Street Address 27 Georgeanne Drive

Legal Description _____

Facility to be connected to sewer:

Single Family Residence ☒ *Multi-family Residential _____ Units _____

*Commercial Installation _____ Description: Street Cut

Water Meter (s) Size 5/8

* Commercial installations, and multi-family installations of more than 4 dwelling units must be accompanied by a site plan showing the proposed building sewer.

Sewer line installation by JWWU

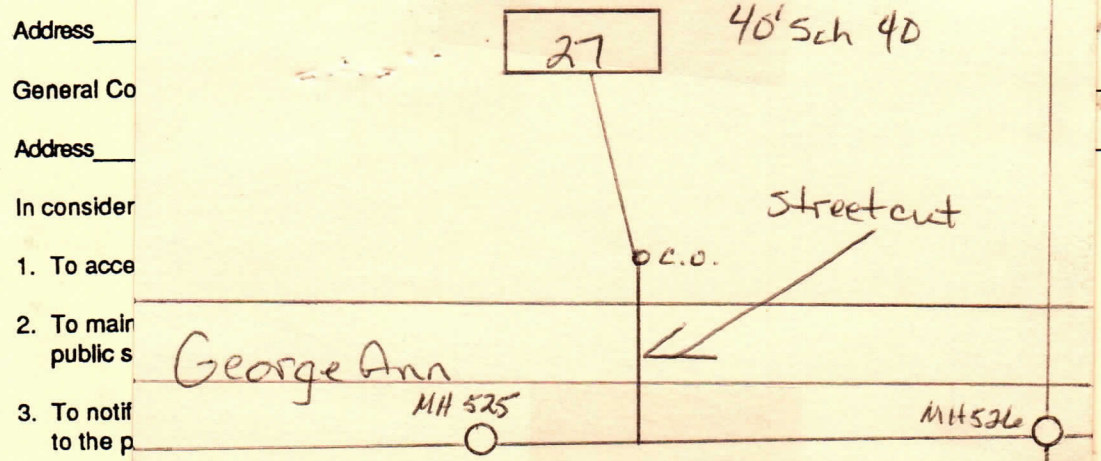

Fees: Connection Fee \$ _____ Receipt No. _____

Tap Charge \$ _____ Receipt No. _____

Inspection Fee \$ _____ Receipt No. _____

Street Cut \$ 1050.00 Receipt No. 8175025

APPLICANT
Signed [Signature]

☐ Plumbing Contractor

☐ General Contract

☐ Owner (Address 944-1905)

SC complete
3/19/14
[initials]

APPROVED
Jacksonville Wastewater Utility

By: Jessica Kendrick Date: 3-11-14