



JACKSONVILLE WASTEWATER UTILITY

248 Cloverdale Rd.
Jacksonville, AR 72076
501-982-0581

No. 16- 0177

RESIDENTIAL OR COMMERCIAL BUILDING SEWER CONNECTION PERMIT

Street Address 29 Preston Court

Legal Description _____

Facility to be connected to sewer:

Single Family Residence ☒ *Multi-family Residential _____ Units _____

*Commercial Installation _____ Description: Replacement

Water Meter (s) Size 5/8

* Commercial installations, and multi-family installations of more than 4 dwelling units must be accompanied by a site plan showing the proposed building sewer.

Sewer line installation by Absolute Plumbing, Drains 749-7942

Address _____

General Cont

Address _____

In consideration

1. To accept

2. To maintain public sewer

3. To notify the public

Fees: Conn

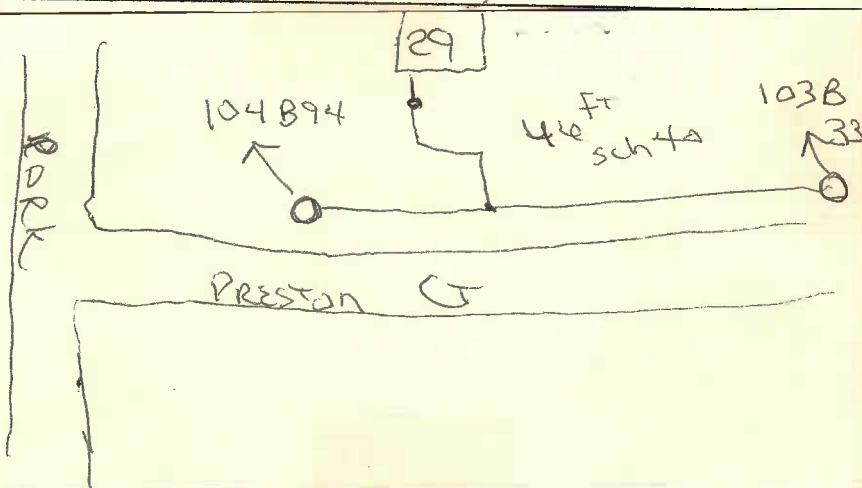

Tap Charge \$ _____

Receipt No. _____

Inspection Fee \$ 25.00

Receipt No. 174020

Street Cut \$ _____

Receipt No. _____

APPLICANT

Signed Daniel Bevilacqua

☐ Plumbing Contractor

☐ General Contract

☐ Owner (Address _____)

Complete
11/10/16
VS

APPROVED
Jacksonville Wastewater Utility

By: Michael Bevilacqua Date: 11/10/16