



JACKSONVILLE WASTEWATER UTILITY
248 Cloverdale Rd.
Jacksonville, AR 72076
501-982-0581

No. 15- 000001

RESIDENTIAL OR COMMERCIAL BUILDING SEWER CONNECTION PERMIT

Street Address 3 Collins Rd

Legal Description _____

Facility to be connected to sewer:

Single Family Residence ☒ *Multi-family Residential _____ Units _____

*Commercial Installation _____ Description: Street cut

Water Meter (s) Size 5/8

* Commercial installations, and multi-family installations of more than 4 dwelling units must be accompanied by a site plan showing the proposed building sewer.

Sewer line installation by JWWU

Address _____

General C _____

Address _____

In consider _____

1. To acc _____

2. To main public s _____

3. To notif to the p _____

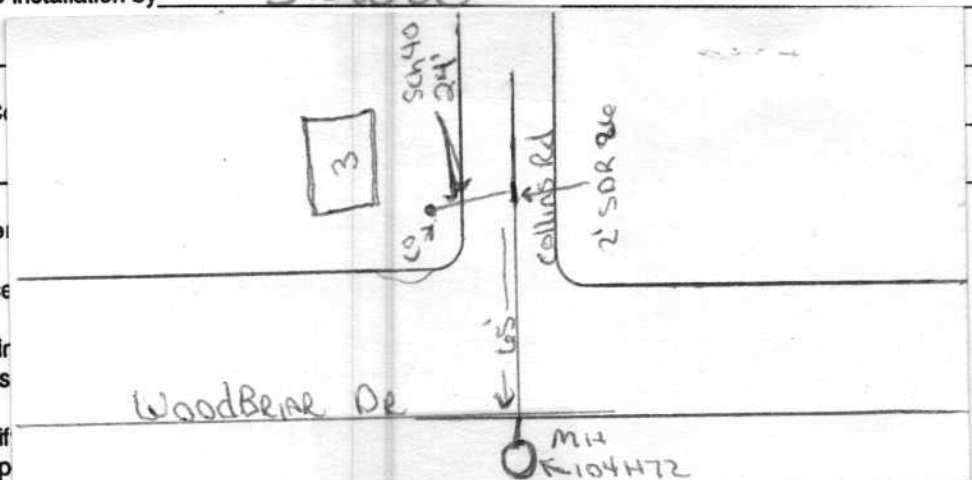

Fees: Connection Fee \$ _____ Receipt No. _____

Tap Charge \$ _____ Receipt No. _____

Inspection Fee \$ _____ Receipt No. _____

Street Cut \$ 1050.00 Receipt No. 423889

APPLICANT
Signed Mr. Norman Wakefield

☐ Plumbing Contractor

☐ General Contract

☒ Owner (Address Mr. Norman Wakefield)

501-744-6325

APPROVED
Jacksonville Wastewater Utility

By: David M. [Signature] Date: 1/5/15

Complete
1/12/15
[Signature]