



No. 03-0186

**JACKSONVILLE WASTEWATER UTILITY**248 Cloverdale Road • P.O. Box 69  
Jacksonville, AR 72078-0069  
982-0581**RESIDENTIAL OR COMMERCIAL BUILDING SEWER CONNECTION PERMIT**Street Address 300 Ranch Ridge CourtLegal Description OAK Ridge Ranch Lot #16

Facility to be connected to sewer:

Single Family Residence ☒ \*Multi-family Residential \_\_\_\_\_ Units \_\_\_\_\_

\*Commercial Installation \_\_\_\_\_ Description: \_\_\_\_\_

Water Meter (s) Size 5/8"

\* Commercial installations, and multi-family installations of more than 4 dwelling units must be accompanied by a site plan showing the proposed building sewer.

Sewer line installation by Harden Plumbing

Address \_\_\_\_\_

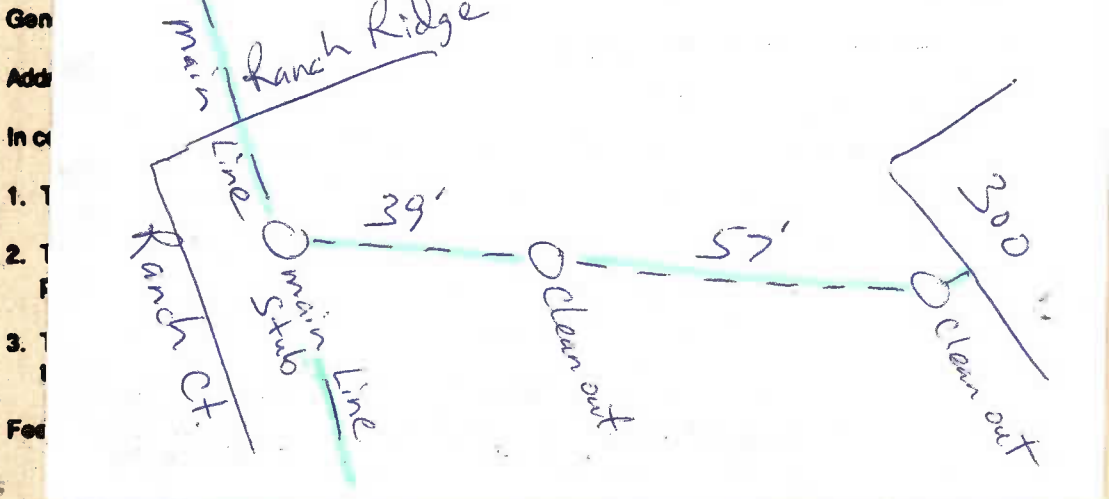
Inspection Fee \$ 6.00Receipt No. 7534

Street Cut \$ \_\_\_\_\_

Receipt No. \_\_\_\_\_

**APPLICANT**Signed [Signature]☐ Plumbing Contractor☐ General Contract☐ Owner (Address \_\_\_\_\_)**APPROVED**

Jacksonville Wastewater Utility

By: [Signature] Date: 7-23-03