



No. 07-0074

JACKSONVILLE WASTEWATER UTILITY

248 Cloverdale Rd.
Jacksonville, AR 72076
501-982-0581

RESIDENTIAL OR COMMERCIAL BUILDING SEWER CONNECTION PERMIT

Street Address 3108 N. First StreetLegal Description Lot 8 Porter's Addition

Facility to be connected to sewer:

Single Family Residence ☒ *Multi-family Residential _____ Units _____*Commercial Installation _____ Description: New ConnectionWater Meter (s) Size 5/8"

* Commercial installations, and multi-family installations of more than 4 dwelling units must be accompanied by a site plan showing the proposed building sewer.

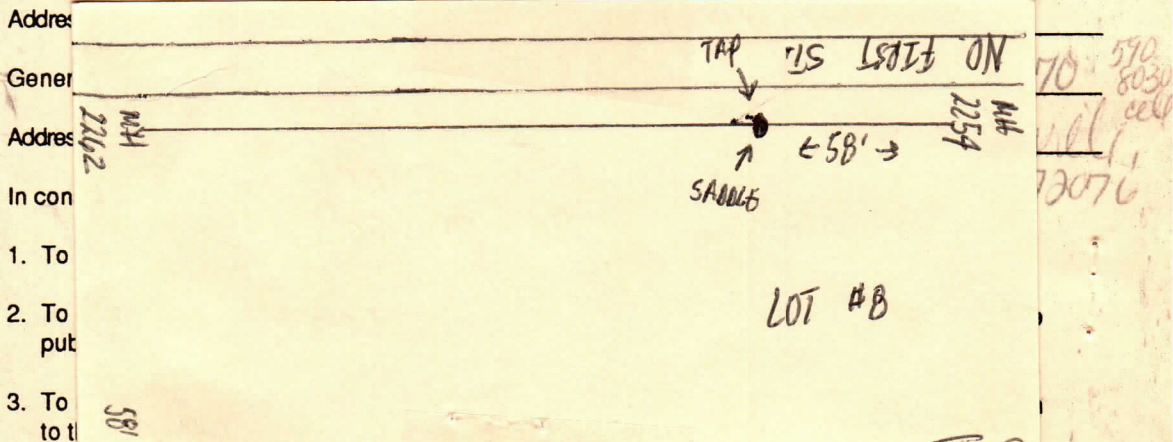
Sewer line installation by Westlake Plumbing - JWWU

Fees:	Connection Fee	\$ <u>12.00</u>	Receipt No. <u>026</u>
	Tap Charge	\$ <u>47.85</u> <u>73.03</u>	Receipt No. <u>856</u>
	Inspection Fee	\$ <u>12.00</u> <u>5/10/07</u>	Receipt No. <u>on Acct</u>
	Street Cut	\$ _____	Receipt No. _____

APPLICANT Signed [Signature]

- ☐ Plumbing Contractor
☐ General Contract
☐ Owner (Address _____)

APPROVED
Jacksonville Wastewater UtilityBy: Jessica Kendrick Date: 4-26-07Inspected
5-10-07

By: W. H. - Noel Date: 3/3/10