



JACKSONVILLE WASTEWATER UTILITY

248 Cloverdale Rd.
Jacksonville, AR 72076
501-982-0581

No. 12-0178

RESIDENTIAL OR COMMERCIAL BUILDING SEWER CONNECTION PERMIT

Street Address 3126 Valentine

Legal Description _____

Facility to be connected to sewer:

Single Family Residence ☒ *Multi-family Residential _____ Units _____

*Commercial Installation _____ Description: New Connection

Water Meter (s) Size 5/8"

* Commercial installations, and multi-family installations of more than 4 dwelling units must be accompanied by a site plan showing the proposed building sewer.

Sewer line installation by Matt Blair At B Place 3450

Address MP5937

General Cor 3126 Valentine Road

Address 60' Sch 40-4"

In considera 225 ft to Matt 3555

1. To accep

2. To maint
public se

3. To notify
to the pu

Fees: Co

Tap Charge \$ _____

Receipt No. _____

Inspection Fee \$ 0

Receipt No. MC

Street Cut \$ _____

Receipt No. _____

APPLICANT

Signed Matt Blair

☐ Plumbing Contractor

☐ General Contract

☐ Owner (Address 115. Centex)

APPROVED

Jacksonville Wastewater Utility

By: Jason Michael Date: 12-3-12



JACKSONVILLE WASTEWATER UTILITY
248 Cloverdale Rd.
Jacksonville, AR 72076
501-982-0581

No. 25- 0051

RESIDENTIAL OR COMMERCIAL BUILDING SEWER CONNECTION PERMIT

Street Address 3126 E. Valentine

Legal Description _____

Facility to be connected to sewer:

Single Family Residence X *Multi-family Residential _____ Units _____

*Commercial Installation _____ Description: Repair

Water Meter (s) Size _____

* Commercial installations, and multi-family installations of more than 4 dwelling units must be accompanied by a site plan showing the proposed building sewer.

Sewer line installation by Complete Plumbing

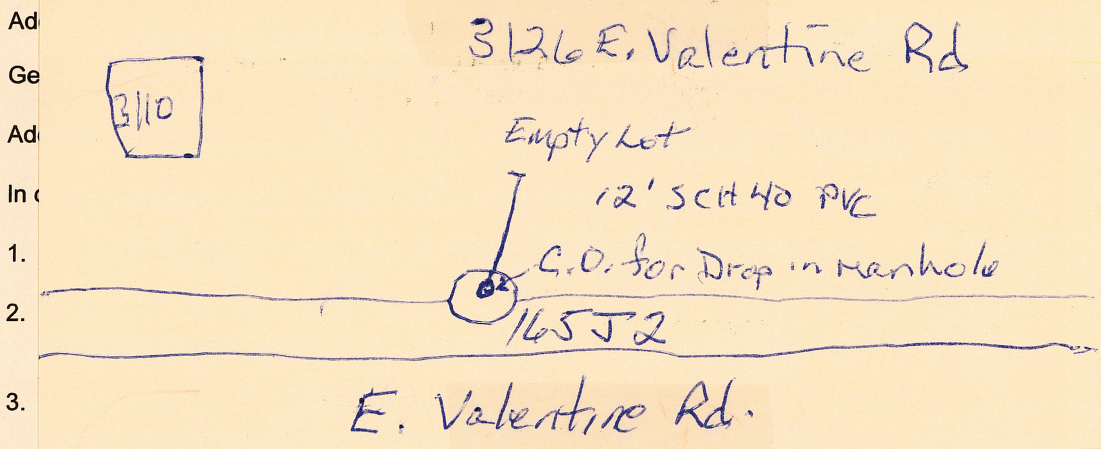

Fee:	Connection Fee	\$ _____	Receipt No. _____
	Tap Charge	\$ _____	Receipt No. _____
	Inspection Fee	\$ <u>25.00</u>	Receipt No. <u>028463</u>
	Street Cut	\$ _____	Receipt No. _____

APPLICANT
Signed Warren per phone
☒ Plumbing Contractor
☐ General Contract
☐ Owner (Address _____)

APPROVED
Jacksonville Wastewater Utility

By: Patty Leach Date: 3/11/25

COMPLETED
3/13/2025