



JACKSONVILLE WASTEWATER UTILITY
248 Cloverdale Road · P.O. Box 69
Jacksonville, AR 72078-0069
982-0581

RESIDENTIAL OR COMMERCIAL BUILDING SEWER CONNECTION PERMIT

Street Address 313 East Valentine

Legal Description _____

Facility to be connected to sewer:

Single Family Residence X *Multi-family Residential _____ Units _____

*Commercial Installation _____ Description: Lept

Water Meter (s) Size 5/8"

* Commercial installations, and multi-family installations of more than 4 dwelling units must be accompanied by a site plan showing the proposed building sewer.

Sewer line installation by William Compton

Address 750 Lehigh Rd Box 9851273

General (_____)
Address _____

In consid.

- 1. To acc
- 2. To ma public
- 3. To not to the

Fees:

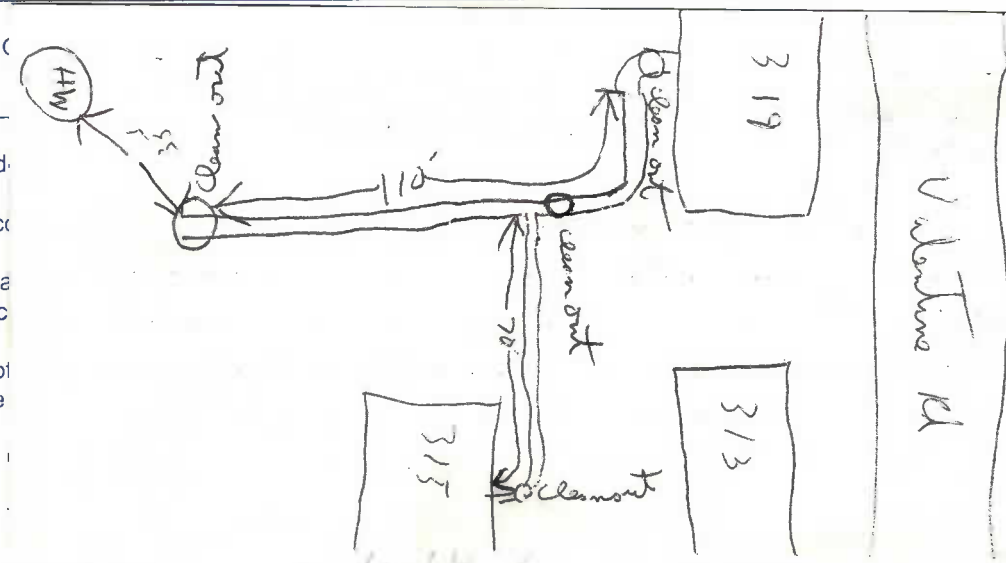

Inspection Fee \$ 6.00

Receipt No. _____

Total Fees \$ _____

APPLICANT
Signed X William Compton

- ☐ Plumbing Contractor
- ☐ General Contract
- ☒ Owner (Address _____)

APPROVED
Jacksonville Wastewater Utility

By: Karen Stew Date: 2-13-98