

No. 88-00104

JACKSONVILLE WASTEWATER UTILITY

RESIDENTIAL OR COMMERCIAL BUILDING SEWER CONNECTION PERMIT

Street Address 316 Southwestern

Legal Description \_\_\_\_\_

Facility to be connected to sewer:

Single Family Residence \_\_\_\_\_ \*Multi-family Residential \_\_\_\_\_ Units \_\_\_\_\_

\*Commercial Installation \_\_\_\_\_ Description: Replacement

Water Meter (s) size 1/2"

\*Commercal installations, and multi-family installations of more than 4 dwelling units must be accompanied by a site plan showing the proposed building sewer.

Sewer line installation by Service Routes

Address \_\_\_\_\_

Ger

Add

In c

1.

2.

3.

Fee

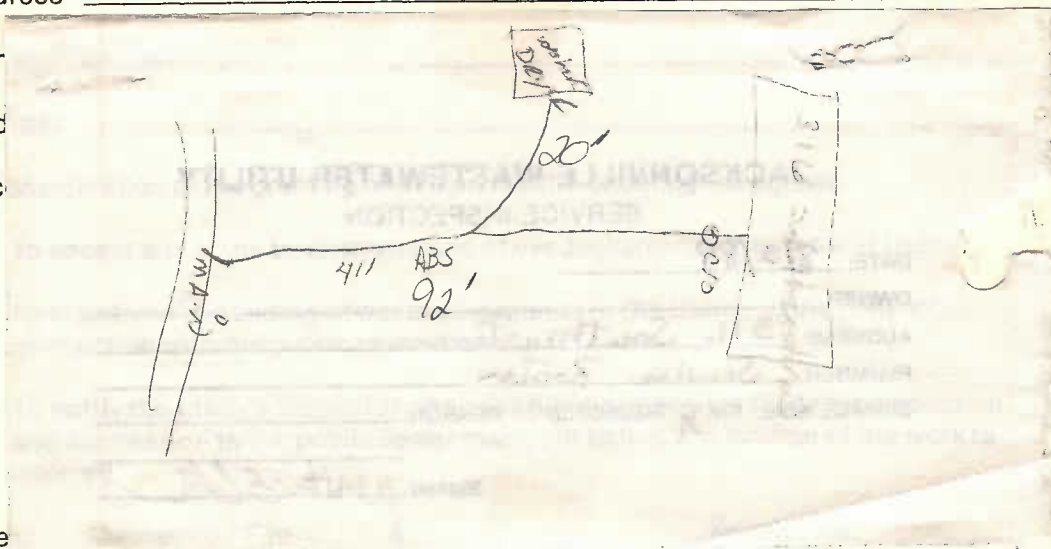

Tap Charge \$ \_\_\_\_\_

Receipt No. \_\_\_\_\_

Inspection Fee \$ 1.00

Receipt No. 212 8-2-88

Total Fees \$ 1.00

APPLICANT

Signed Richard A. P. Jr.

- ☐ Plumbing Contractor
- ☐ General Contract
- ☐ Owner (Address \_\_\_\_\_)

APPROVED  
Jacksonville Wastewater Utility

By: Miss B. B. B.

Date: 8/2/88