



No. 03-0141

JACKSONVILLE WASTEWATER UTILITY

248 Cloverdale Road · P.O. Box 69
Jacksonville, AR 72078-0069
982-0581

RESIDENTIAL OR COMMERCIAL BUILDING SEWER CONNECTION PERMIT

Street Address

3309 South Ridge Dr.

Legal Description

Western Hills Lot # 55

Facility to be connected to sewer:

Single Family Residence



*Multi-family Residential

Units

*Commercial Installation

Description:

Water Meter (s) Size

5/8

* Commercial installations, and multi-family installations of more than 4 dwelling units must be accompanied by a site plan showing the proposed building sewer.

Sewer line installation by

Westlake Plumbing

Address

General Contractor

Address

In consideration of

1. To accept

2. To maintain public sewer

3. To notify to the public

Fees: Cor

Tap Charge

\$

Inspection Fee

\$

Street Cut

\$

Receipt No.

Receipt No.

Receipt No.

APPLICANT

Signed

☐ Plumbing Contractor☐ General Contractor☐ Owner (Address _____)

APPROVED

Jacksonville Wastewater Utility

By:

Date:

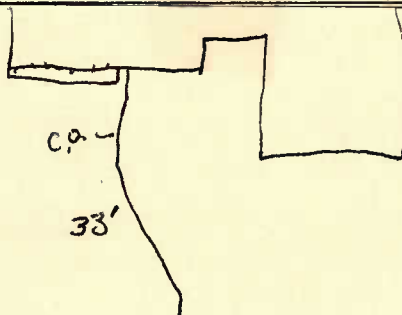

7430