



No. 03-0225

JACKSONVILLE WASTEWATER UTILITY

248 Cloverdale Road • P.O. Box 69
Jacksonville, AR 72078-0069
982-0581

RESIDENTIAL OR COMMERCIAL BUILDING SEWER CONNECTION PERMIT

Street Address 3500 Longstreet St.

Legal Description Crooked Creek Sub Lot # 15

Facility to be connected to sewer:

Single Family Residence ☒ *Multi-family Residential _____ Units _____

*Commercial Installation _____ Description: _____

Water Meter (s) Size 5/8"

* Commercial installations, and multi-family installations of more than 4 dwelling units must be accompanied by a site plan showing the proposed building sewer.

Sewer line installation by Westlake Plumbing

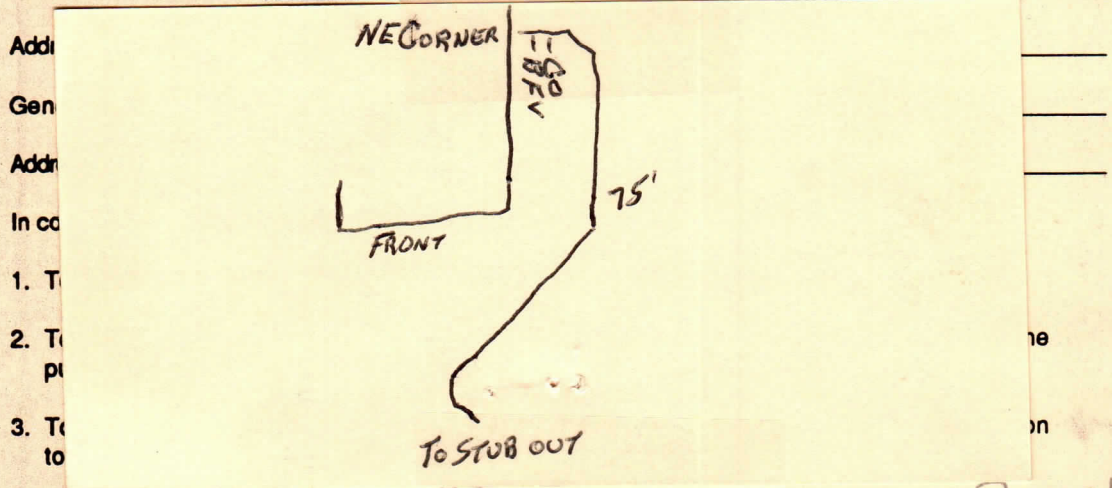

Fees:	Connection Fee	\$ <u>70.</u>	Receipt No. <u>2051</u>
	Tap Charge	\$ _____	Receipt No. _____
	Inspection Fee	\$ <u>10.00</u>	Receipt No. <u>2005</u>
	Street Cut	\$ _____	Receipt No. _____

APPLICANT
Signed Bill Pham
☐ Plumbing Contractor
☐ General Contract
☐ Owner (Address _____)

APPROVED
Jacksonville Wastewater Utility
By: Mark Palmiter Date: 9-18-03