



No. 03-0153

JACKSONVILLE WASTEWATER UTILITY248 Cloverdale Road • P.O. Box 69
Jacksonville, AR 72078-0069
982-0581**RESIDENTIAL OR COMMERCIAL BUILDING SEWER CONNECTION PERMIT**Street Address 3500 South RidgeLegal Description Western Hills Lot #44

Facility to be connected to sewer:

Single Family Residence ☒ *Multi-family Residential _____ Units _____

*Commercial Installation _____ Description: _____

Water Meter (s) Size 5/8"

* Commercial installations, and multi-family installations of more than 4 dwelling units must be accompanied by a site plan showing the proposed building sewer.

Sewer line installation by Bill McPherson Westlake

Address _____

General Cont

Address 59

In consideration of

1. To accept

2. To maintain public sewer

3. To notify to the public

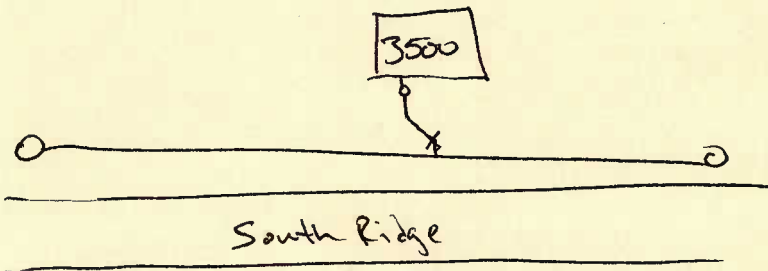

Fees: Cont

Tap Charge \$ _____

Receipt No. _____

Inspection Fee \$ 6.00Receipt No. 7430

Street Cut \$ _____

Receipt No. _____

APPLICANT

Signed Donna Turner☐ Plumbing Contractor☐ General Contract☐ Owner (Address _____)

APPROVED

Jacksonville Wastewater Utility

By: North M. Palenik Date: 5-28-03