



JACKSONVILLE WASTEWATER UTILITY

248 Cloverdale Road · P.O. Box 69
Jacksonville, AR 72078-0069
982-0581

No. 97-

195

RESIDENTIAL OR COMMERCIAL BUILDING SEWER CONNECTION PERMIT

Street Address 3501 John Harden

Legal Description same as above

Facility to be connected to sewer:

Single Family Residence _____ *Multi-family Residential _____ Units _____

*Commercial Installation _____ Description: Church

Water Meter (s) Size 2"

* Commercial installations, and multi-family installations of more than 4 dwelling units must be accompanied by a site plan showing the proposed building sewer.

Sewer line installation by Jim Master ^{Plumbers} #2977

AR 72115 758.6363
etal Bldgo.

John Harden Dr

PARKING
LOT

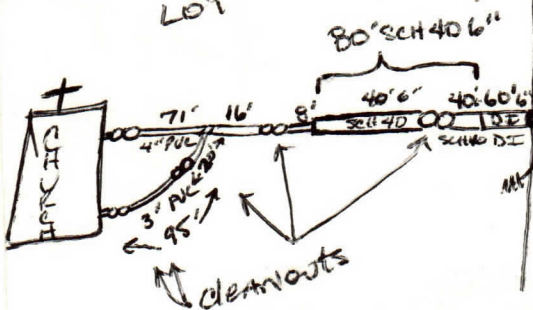

I, undersigned agrees:

Jacksonville Wastewater Utility.

to the Utility, to the point of connection with the

g sewer is ready for inspection and connection
n of the work is covered.

10-15-97-8917
Receipt No. 434390

JOHN HARDEN DRIVE

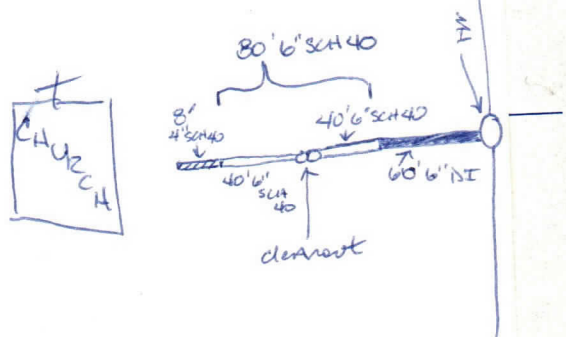

By: Jim Master



No. 04- 0222

JACKSONVILLE WASTEWATER UTILITY248 Cloverdale Road • P.O. Box 69
Jacksonville, AR 72078-0069
982-0581**RESIDENTIAL OR COMMERCIAL BUILDING SEWER CONNECTION PERMIT**Street Address 3501 John HardenLegal Description McArthur Drive Assembly of God

Facility to be connected to sewer:

Single Family Residence _____ *Multi-family Residential _____ Units _____

*Commercial Installation _____ Description: _____

Water Meter (s) Size _____

* Commercial installations, and multi-family installations of more than 4 dwelling units must be accompanied by a site plan showing the proposed building sewer.

Sewer line installation by Jim Davis Plumbing

Address _____

General Contractor _____

Address _____

In consideration of _____

1. To accept _____

2. To maintain public sewer _____

3. To notify to the public _____

Fees: Connection Fee \$ _____ Receipt No. _____

Tap Charge \$ _____ Receipt No. _____

Inspection Fee \$ 6.00 Receipt No. 88216

Street Cut \$ _____ Receipt No. _____

APPLICANT
Signed John Davis☐ Plumbing Contractor☐ General Contractor☐ Owner (Address _____)APPROVED
Jacksonville Wastewater UtilityBy: John Davis Date: 21 Sep 04