



No. 98 - 362

JACKSONVILLE WASTEWATER UTILITY

248 Cloverdale Road • P.O. Box 69
Jacksonville, AR 72078-0069
982-0581

RESIDENTIAL OR COMMERCIAL BUILDING SEWER CONNECTION PERMIT

Street Address 3506 Spring Valley CoveLegal Description Lot 14 Spring Valley Subd.

Facility to be connected to sewer:

Single Family Residence ☒ *Multi-family Residential _____ Units _____

*Commercial Installation _____ Description: _____

Water Meter (s) Size 5/8

* Commercial installations, and multi-family installations of more than 4 dwelling units must be accompanied by a site plan showing the proposed building sewer.

Sewer line installation by Harder

Address _____

General C

Address _____

In consid

1. To acc

2. To ma
public3. To not
to the

Fees: (

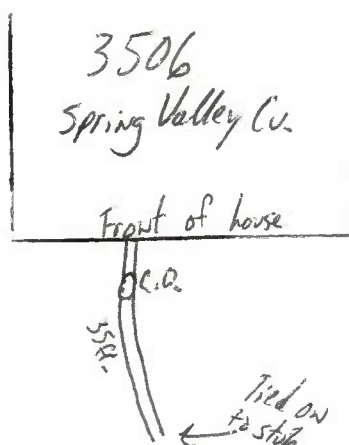
Inspection Fee \$ 6.00Receipt No. 4206Total Fees \$ 75.00

APPLICANT

Signed [Signature] 12615☐ Plumbing Contractor☐ General Contract☐ Owner (Address _____)

APPROVED

Jacksonville Wastewater Utility

By: Susan Davitt Date: 12-17-98