



No. 03-0197

JACKSONVILLE WASTEWATER UTILITY

248 Cloverdale Road • P.O. Box 69
Jacksonville, AR 72078-0069
982-0581

RESIDENTIAL OR COMMERCIAL BUILDING SEWER CONNECTION PERMITStreet Address 3604 Longstreet StreetLegal Description Lot 53 Crooked Creek PH I

Facility to be connected to sewer:

Single Family Residence ☒ *Multi-family Residential _____ Units _____

*Commercial Installation _____ Description: _____

Water Meter (s) Size 5/8

* Commercial installations, and multi-family installations of more than 4 dwelling units must be accompanied by a site plan showing the proposed building sewer.

Sewer line installation by R4S Plumbing

Address _____

General Co _____

Address _____

In consideration of _____

1. To accept _____

2. To maintain public sewer _____

3. To notify to the public _____

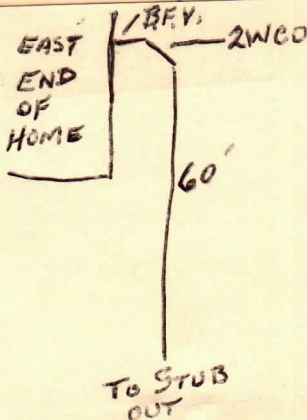
Fees: Connection Fee \$ 15.00 Receipt No. 7589

Tap Charge \$ _____ Receipt No. _____

Inspection Fee \$ 6.00 Receipt No. 2124

Street Cut \$ _____ Receipt No. _____

APPLICANT Signed Steven Allgood☐ Plumbing Contractor☐ General Contract☐ Owner (Address _____)

APPROVED

Jacksonville Wastewater Utility

By: Susan Davitt Date: 8-15-03