



JACKSONVILLE WASTEWATER UTILITY

248 Cloverdale Road · P.O. Box 69
Jacksonville, AR 72078-0069
982-0581

No. 04-0015

RESIDENTIAL OR COMMERCIAL BUILDING SEWER CONNECTION PERMIT

Street Address 3700 Longstreet Street

Legal Description Crooked Creek Lot # 83

Facility to be connected to sewer:

Single Family Residence ☒ *Multi-family Residential _____ Units _____

*Commercial Installation _____ Description: _____

Water Meter (s) Size 5/8"

* Commercial installations, and multi-family installations of more than 4 dwelling units must be accompanied by a site plan showing the proposed building sewer.

Sewer line installation by Lanote Plumbing

Address _____

General _____

Address _____

In consi _____

1. To a _____

2. To m
publi _____

3. To ne
to the _____

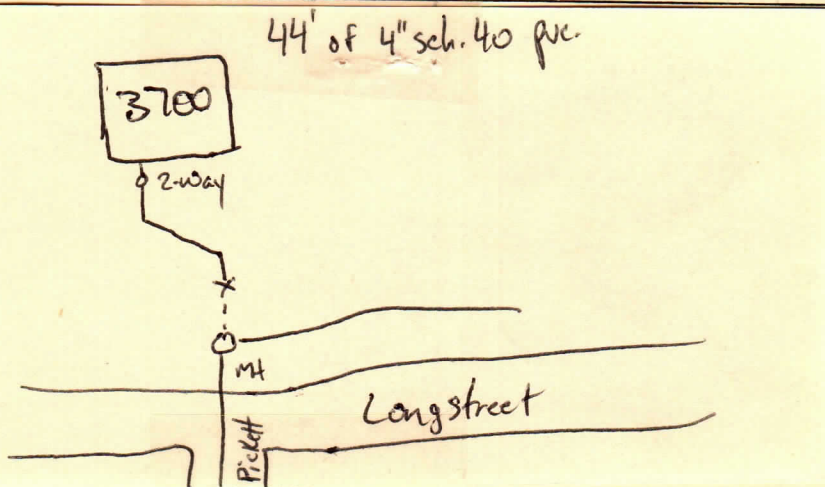

Fees: Connection Fee \$ 75.00

Receipt No. 2065

Tap Charge \$ _____

Receipt No. _____

Inspection Fee \$ 6.00

Receipt No. 2208

Street Cut \$ _____

Receipt No. 5.4.04

APPLICANT

Signed Stacy Allard

☐ Plumbing Contractor

☐ General Contract

☐ Owner (Address _____)

APPROVED

Jacksonville Wastewater Utility

By: Keith [Signature] Date: 2-2-04