



No. 04- 0197

JACKSONVILLE WASTEWATER UTILITY248 Cloverdale Road • P.O. Box 69
Jacksonville, AR 72078-0069
982-0581**RESIDENTIAL OR COMMERCIAL BUILDING SEWER CONNECTION PERMIT**Street Address 400 Cypress CourtLegal Description Lot # 37 Oak Ridge Ranch

Facility to be connected to sewer:

Single Family Residence ☒ *Multi-family Residential _____ Units _____

*Commercial Installation _____ Description: _____

Water Meter (s) Size 5/8"

* Commercial installations, and multi-family installations of more than 4 dwelling units must be accompanied by a site plan showing the proposed building sewer.

Sewer line installation by Harden

Address _____

General _____

Address _____

In consid _____

1. To ac _____

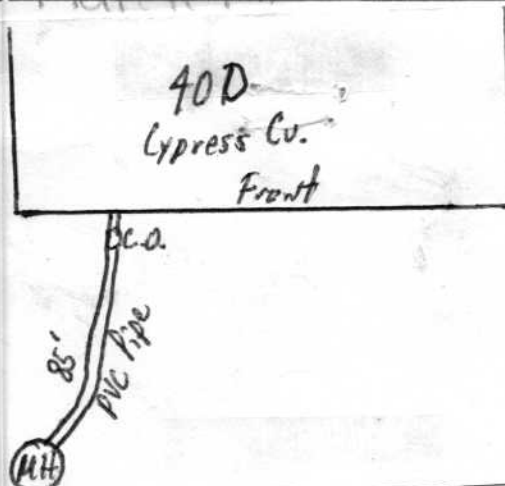
2. To ma
public _____3. To not
to the _____Fees: Connection Fee \$ 15.00Receipt No. 8844

Tap Charge \$ _____

Receipt No. _____

Inspection Fee \$ 12.00Receipt No. 9188

Street Cut \$ _____

Receipt No. _____

APPLICANTSigned [Signature]☐ Plumbing Contractor☐ General Contract☐ Owner (Address _____)APPROVED
Jacksonville Wastewater UtilityBy: [Signature] Date: 10/14/04