



JACKSONVILLE WASTEWATER UTILITY  
248 Cloverdale Rd.  
Jacksonville, AR 72076  
501-982-0581

No. 18-0043

RESIDENTIAL OR COMMERCIAL BUILDING SEWER CONNECTION PERMIT

Street Address 401 N First Street

Legal Description \_\_\_\_\_

Facility to be connected to sewer:

Single Family Residence ☒ \*Multi-family Residential \_\_\_\_\_ Units \_\_\_\_\_

\*Commercial Installation \_\_\_\_\_ Description: Spot Repair

Water Meter (s) Size \_\_\_\_\_

\* Commercial installations, and multi-family installations of more than 4 dwelling units must be accompanied by a site plan showing the proposed building sewer.

Sewer line installation by WWM - Cody

Address \_\_\_\_\_

General \_\_\_\_\_

Address \_\_\_\_\_

In connection \_\_\_\_\_

1. To \_\_\_\_\_

2. To \_\_\_\_\_  
puls \_\_\_\_\_

3. To \_\_\_\_\_  
to \_\_\_\_\_

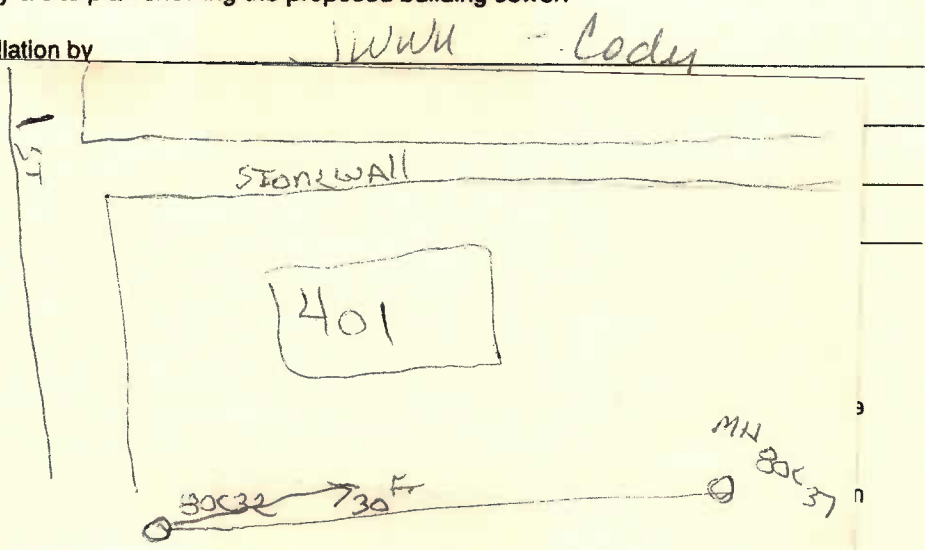

Fees: Connection Fee \$ \_\_\_\_\_ Receipt No. \_\_\_\_\_

Tap Charge \$ \_\_\_\_\_ Receipt No. \_\_\_\_\_

Inspection Fee \$ 0 Receipt No. N/C

Street Cut \$ \_\_\_\_\_ Receipt No. \_\_\_\_\_

APPLICANT

Signed N/A

☐ Plumbing Contractor

☐ General Contract

☐ Owner (Address \_\_\_\_\_)

David M.

Complete  
7/10/18

APPROVED

Jacksonville Wastewater Utility

By: [Signature] Date: 7-10-18