



No. 05-0151

# JACKSONVILLE WASTEWATER UTILITY

248 Cloverdale Road • P.O. Box 69  
Jacksonville, AR 72078-0069  
982-0581

## RESIDENTIAL OR COMMERCIAL BUILDING SEWER CONNECTION PERMIT

Street Address 401 W. State Valentine Rd

Legal Description Lot 23 Cloverbridge PH1

Facility to be connected to sewer:

Single Family Residence ☒ \*Multi-family Residential \_\_\_\_\_ Units \_\_\_\_\_

\*Commercial Installation \_\_\_\_\_ Description: \_\_\_\_\_

Water Meter (s) Size 3/4"

\* Commercial installations, and multi-family installations of more than 4 dwelling units must be accompanied by a site plan showing the proposed building sewer.

Sewer line installation by Shaffer Plumbing

Address \_\_\_\_\_

General C

Address \_\_\_\_\_

In consider

1. To acco

2. To main

3. To notif

to the p

Fees: C

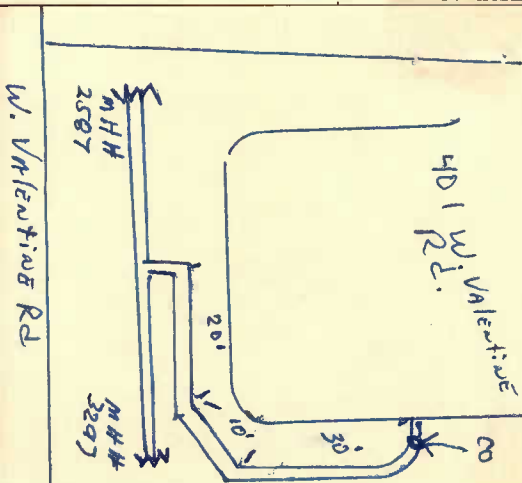

Tap Charge \$ 12.00

Inspection Fee \$ 24.00

Street Cut \$ \_\_\_\_\_

Receipt No. \_\_\_\_\_

Receipt No. 9219

Receipt No. 7.21.05

APPLICANT

Signed \_\_\_\_\_

☐ Plumbing Contractor

☐ General Contract

☐ Owner (Address \_\_\_\_\_)

APPROVED

Jacksonville Wastewater Utility

By: [Signature] Date: 5/10/05