



JACKSONVILLE WASTEWATER UTILITY
248 Cloverdale Rd.
Jacksonville, AR 72076
501-982-0581

No. 06- 0287

RESIDENTIAL OR COMMERCIAL BUILDING SEWER CONNECTION PERMIT

Street Address 403 Franklin Street

Legal Description Lot 14 Graham Settlement

Facility to be connected to sewer:

Single Family Residence X *Multi-family Residential _____ Units _____

*Commercial Installation _____ Description: New Connection / Tap

Water Meter (s) Size 5/8

* Commercial installations, and multi-family installations of more than 4 dwelling units must be accompanied by a site plan showing the proposed building sewer.

Sewer line installation by Henry Home Town Plumbing V.B. Plumbing

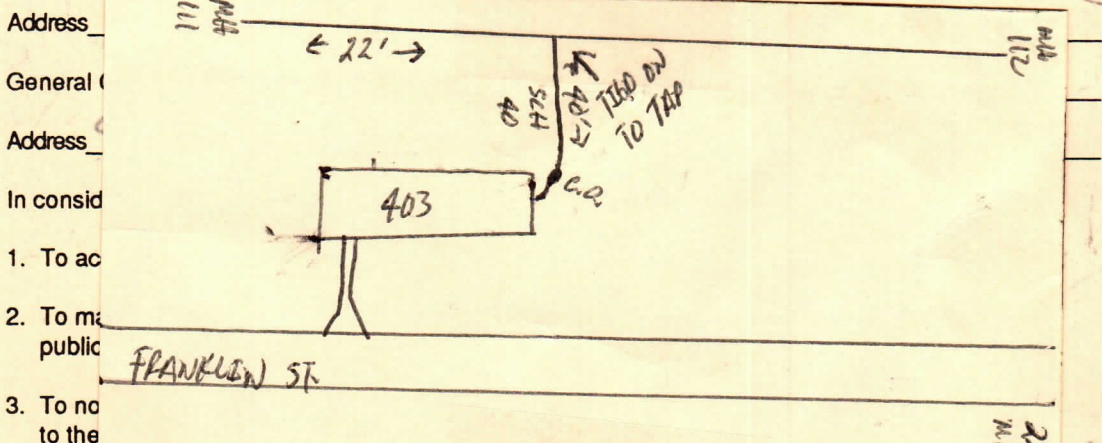

Fees:	Connection Fee	\$ <u>12.00</u>	11/10/06	Receipt No. _____
	Tap Charge	\$ <u>49.22</u>	2/15/07	Receipt No. <u>2745</u>
	Inspection Fee	\$ <u>12.00</u>		Receipt No. <u>2745</u>
	Street Cut	\$ _____		Receipt No. _____

APPLICANT
Signed Shahabpur

☐ Plumbing Contractor
☐ General Contract
☐ Owner (Address _____)

APPROVED
Jacksonville Wastewater Utility

By: [Signature] Date: 09-26-06