



No. 06- 0095

**JACKSONVILLE WASTEWATER UTILITY**  
248 Cloverdale Rd.  
Jacksonville, AR 72076  
501-982-0581

**RESIDENTIAL OR COMMERCIAL BUILDING SEWER CONNECTION PERMIT**

Street Address 404 Cypress CourtLegal Description Lot 38 Oak Ridge Ranch

Facility to be connected to sewer:

Single Family Residence X \*Multi-family Residential \_\_\_\_\_ Units \_\_\_\_\_

\*Commercial Installation \_\_\_\_\_ Description: \_\_\_\_\_

Water Meter (s) Size 5/8

\* Commercial installations, and multi-family installations of more than 4 dwelling units must be accompanied by a site plan showing the proposed building sewer.

Sewer line installation by Marks Plumbing 551-8912

Address \_\_\_\_\_

General \_\_\_\_\_

Address \_\_\_\_\_

In consid \_\_\_\_\_

1. To a \_\_\_\_\_

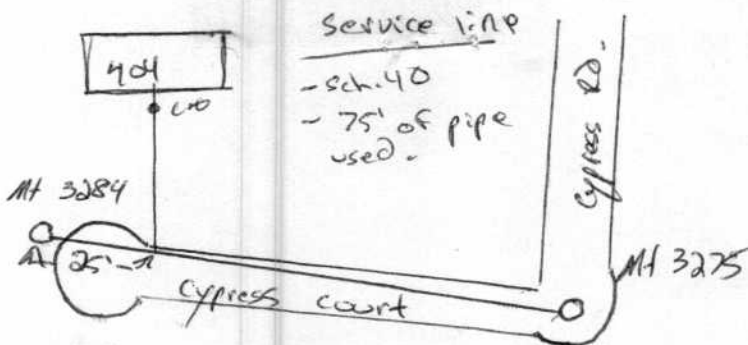
2. To m  
publi3. To n  
to theFees: Connection Fee \$ 15.00 Receipt No. 2521

Tap Charge \$ \_\_\_\_\_ Receipt No. \_\_\_\_\_

Inspection Fee \$ 12.00 1-24-07 Receipt No. on Acct

Street Cut \$ \_\_\_\_\_ Receipt No. \_\_\_\_\_

APPLICANT

Signed [Signature]☐ Plumbing Contractor☐ General Contract☐ Owner (Address \_\_\_\_\_)

APPROVED

Jacksonville Wastewater Utility

By: [Signature] Date: 08-14-06Inspected  
1-26-07