



JACKSONVILLE WASTEWATER UTILITY
248 Cloverdale Rd.
Jacksonville, AR 72076
501-982-0581

No. 14- 0138

RESIDENTIAL OR COMMERCIAL BUILDING SEWER CONNECTION PERMIT

Street Address 405 Harris Road

Legal Description Lot 7, Maple Wood

Facility to be connected to sewer:

Single Family Residence _____ *Multi-family Residential _____ Units _____

*Commercial Installation 5/8 Description: New Connection

Water Meter (s) Size _____

* Commercial installations, and multi-family installations of more than 4 dwelling units must be accompanied by a site plan showing the proposed building sewer.

Sewer line Installation by Westlake Plumbing

Address _____

General Code HARRIS RD

Address _____

In consideration of:

1. To accept
2. To maintain public sewer
3. To notify to the public

Forest Dr

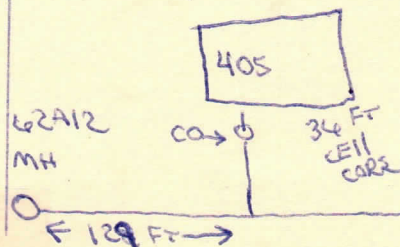

Fees: Connection Fee \$ _____

Receipt No. 815950

Tap Charge \$ _____

Receipt No. _____

Inspection Fee \$ 25.00

Receipt No. on acct

Street Cut \$ _____

Receipt No. _____

APPLICANT

Signed Lacey Spauld

☐ Plumbing Contractor

☐ General Contract

☐ Owner (Address _____)

APPROVED
Jacksonville Wastewater Utility

By: [Signature]

Date: 10 Sept 14

Complete
9/25/14
[Signature]

cut # 3039